

Cast Iron Sheaves - Heavy Duty
Bushed, One and Two Groove
A-B QD Sheaves
Order part number size
Example: 1B34SH

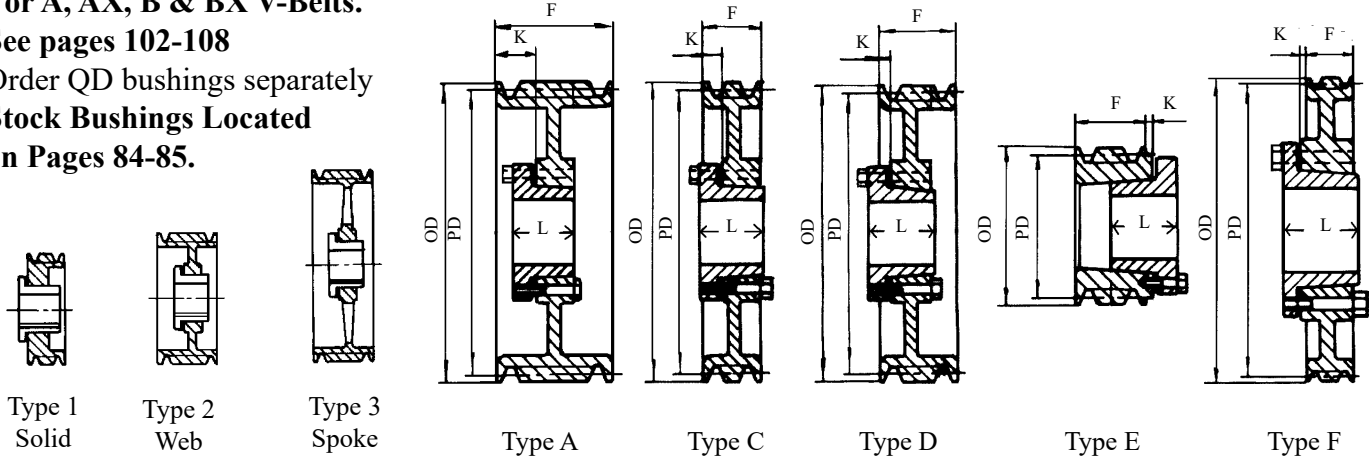

For A, AX, B & BX V-Belts.
See pages 102-108
Order QD bushings separately
Stock Bushings Located
on Pages 84-85.



| O.D. | P.D. | | 1 Groove F = 1B34SH THRU 1B64SDS = 7/8 1B66SDS THRU 1B300SF = 1 | | | | | | 2 Groove F = 1 3/4 | | | | | |
|-------|-------|-------|--|------|------|------|---------|------|--------------------|------|------|-------|---------|-------|
| | A | B | Part No. | Bush | Type | K | L | WT. | Part No. | Bush | Type | K | L | WT. |
| 3.75 | 3.00 | 3.40 | 1B34SH | SH | D-1 | 0 | 1 5/16 | 1.4 | *2B34SH | SH | E-1 | 0 | 1 5/16 | 2.4 |
| 3.95 | 3.20 | 3.60 | 1B36SH | SH | D-1 | 0 | 1 5/16 | 1.6 | *2B36SH | SH | D-1 | 3/16 | 1 5/16 | 2.7 |
| 4.15 | 3.40 | 3.80 | 1B38SH | SH | D-1 | 0 | 1 5/16 | 1.7 | *2B38SH | SH | D-1 | 3/16 | 1 5/16 | 2.9 |
| 4.35 | 3.60 | 4.00 | 1B40SH | SH | C-1 | 1/16 | 1 5/16 | 1.9 | +2B40SH | SH | A-1 | 11/16 | 1 5/16 | 3.2 |
| 4.55 | 3.80 | 4.20 | 1B42SH | SH | C-1 | 1/16 | 1 5/16 | 2.2 | +2B42SH | SH | A-1 | 11/16 | 1 5/16 | 3.7 |
| 4.75 | 4.00 | 4.40 | 1B44SH | SH | C-1 | 1/16 | 1 5/16 | 2.5 | 2B44SH | SH | A-1 | 11/16 | 1 5/16 | 4.1 |
| 4.95 | 4.20 | 4.60 | 1B46SDS | SDS | C-1 | 1/8 | 1 5/16 | 2.5 | 2B46SDS | SDS | A-1 | 11/16 | 1 5/16 | 4.2 |
| 5.15 | 4.40 | 4.80 | 1B48SDS | SDS | C-1 | 1/8 | 1 5/16 | 2.8 | 2B48SDS | SDS | A-1 | 11/16 | 1 5/16 | 4.6 |
| 5.35 | 4.60 | 5.00 | 1B50SDS | SDS | C-1 | 1/8 | 1 5/16 | 3.1 | 2B50SDS | SDS | A-1 | 11/16 | 1 5/16 | 5.0 |
| 5.55 | 4.80 | 5.20 | 1B52SDS | SDS | C-1 | 1/8 | 1 5/16 | 3.3 | 2B52SDS | SDS | A-1 | 11/16 | 1 5/16 | 5.4 |
| 5.75 | 5.00 | 5.40 | 1B54SDS | SDS | C-1 | 1/8 | 1 5/16 | 3.7 | 2B54SDS | SDS | A-1 | 11/16 | 1 5/16 | 5.8 |
| 5.95 | 5.20 | 5.60 | 1B56SDS | SDS | C-1 | 1/8 | 1 5/16 | 4.2 | 2B56SDS | SDS | A-1 | 11/16 | 1 5/16 | 6.1 |
| 6.15 | 5.40 | 5.80 | 1B58SDS | SDS | C-1 | 1/8 | 1 5/16 | 3.9 | 2B58SDS | SDS | A-1 | 11/16 | 1 5/16 | 6.1 |
| 6.35 | 5.60 | 6.00 | 1B60SDS | SDS | C-2 | 1/8 | 1 5/16 | 4.0 | 2B60SDS | SDS | A-2 | 11/16 | 1 5/16 | 6.4 |
| 6.55 | 5.80 | 6.20 | 1B62SDS | SDS | C-2 | 1/8 | 1 5/16 | 4.2 | 2B62SDS | SDS | A-2 | 11/16 | 1 5/16 | 6.7 |
| 6.75 | 6.00 | 6.40 | 1B64SDS | SDS | C-2 | 1/8 | 1 5/16 | 4.3 | 2B64SDS | SDS | A-2 | 11/16 | 1 5/16 | 7.1 |
| 6.95 | 6.20 | 6.60 | 1B66SDS | SDS | C-2 | 1/4 | 1 5/16 | 5.1 | 2B66SDS | SDS | A-2 | 11/16 | 1 5/16 | 7.6 |
| 7.15 | 6.40 | 6.80 | 1B68SDS | SDS | C-2 | 1/4 | 1 5/16 | 5.3 | 2B68SDS | SDS | A-2 | 11/16 | 1 5/16 | 7.8 |
| 7.35 | 6.60 | 7.00 | 1B70SDS | SDS | C-2 | 1/4 | 1 5/16 | 5.6 | 2B70SK | SK | D-2 | 7/16 | 1 15/16 | 9.5 |
| 7.75 | 7.00 | 7.40 | 1B74SDS | SDS | C-2 | 1/4 | 1 5/16 | 6.0 | 2B74SK | SK | D-2 | 7/16 | 1 15/16 | 10.2 |
| 8.35 | 7.60 | 8.00 | 1B80SDS | SDS | C-2 | 1/4 | 1 5/16 | 6.6 | 2B80SK | SK | D-2 | 7/16 | 1 15/16 | 10.8 |
| 8.95 | 8.20 | 8.60 | 1B86SDS | SDS | C-3 | 1/4 | 1 5/16 | 6.8 | 2B86SK | SK | D-3 | 7/16 | 1 15/16 | 11.7 |
| 9.35 | 8.60 | 9.00 | 1B90SDS | SDS | C-3 | 1/4 | 1 5/16 | 7.0 | 2B90SK | SK | D-3 | 7/16 | 1 15/16 | 13.0 |
| 9.75 | 9.00 | 9.40 | 1B94SDS | SDS | C-3 | 1/4 | 1 5/16 | 7.4 | 2B94SK | SK | D-3 | 7/16 | 1 15/16 | 13.2 |
| 11.35 | 10.60 | 11.00 | 1B110SDS | SDS | C-3 | 1/4 | 1 5/16 | 10.5 | 2B110SK | SK | D-3 | 7/16 | 1 15/16 | 16.4 |
| 12.75 | 12.00 | 12.40 | 1B124SDS | SDS | C-3 | 1/4 | 1 5/16 | 11.5 | 2B124SK | SK | D-3 | 7/16 | 1 15/16 | 18.3 |
| 13.95 | 13.20 | 13.60 | 1B136SDS | SDS | C-3 | 1/4 | 1 5/16 | 12.9 | 2B136SK | SK | D-3 | 7/16 | 1 15/16 | 20.3 |
| 15.75 | 15.00 | 15.40 | 1B154SK | SK | F-3 | 1/4 | 1 15/16 | 17.1 | 2B154SK | SK | D-3 | 7/16 | 1 15/16 | 23.8 |
| 16.35 | 15.60 | 16.00 | 1B160SK | SK | F-3 | 1/4 | 1 15/16 | 18.6 | 2B160SK | SK | D-3 | 7/16 | 1 15/16 | 24.3 |
| 18.75 | 18.00 | 18.40 | 1B184SK | SK | F-3 | 1/4 | 1 15/16 | 23.8 | 2B184SK | SK | D-3 | 7/16 | 1 15/16 | 31.8 |
| 20.35 | 19.60 | 20.00 | 1B200SK | SK | F-3 | 1/4 | 1 15/16 | 27.0 | 2B200SF | SF | D-3 | 3/8 | 2 1/16 | 33.4 |
| 25.35 | 24.60 | 25.00 | 1B250SF | SF | F-3 | 1/4 | 2 1/16 | 39.0 | 2B250SF | SF | D-3 | 3/8 | 2 1/16 | 45.0 |
| 30.35 | 29.60 | 30.00 | 1B300SF | SF | F-3 | 1/4 | 2 1/16 | 57.0 | 2B300SF | SF | D-3 | 3/8 | 2 1/16 | 71.2 |
| 38.35 | 37.60 | 38.00 | | | | | | | 2B380SF | SF | D-3 | 3/8 | 2 1/16 | 103.0 |

* = Can only be mounted from one direction.

+ = Includes cap screws to be used in place of the ones that come with the bushing.

Note: Cast iron sheaves may not exceed 6500 FPM. This speed **DOES NOT** specify if dynamic balancing (2 plane) is required. Contact customer service to verify whether dynamic balancing is required.

QD Bushing Sheaves

Cast Iron Sheaves - Heavy Duty
Bushed, Three and Four Groove
A-B QD Sheaves
Order part number size
Example: 3B34SH



For A, AX, B & BX V-Belts. See pages 102-108.
Order QD bushings separately.
Stock Bushings Located on Pages 84-85.

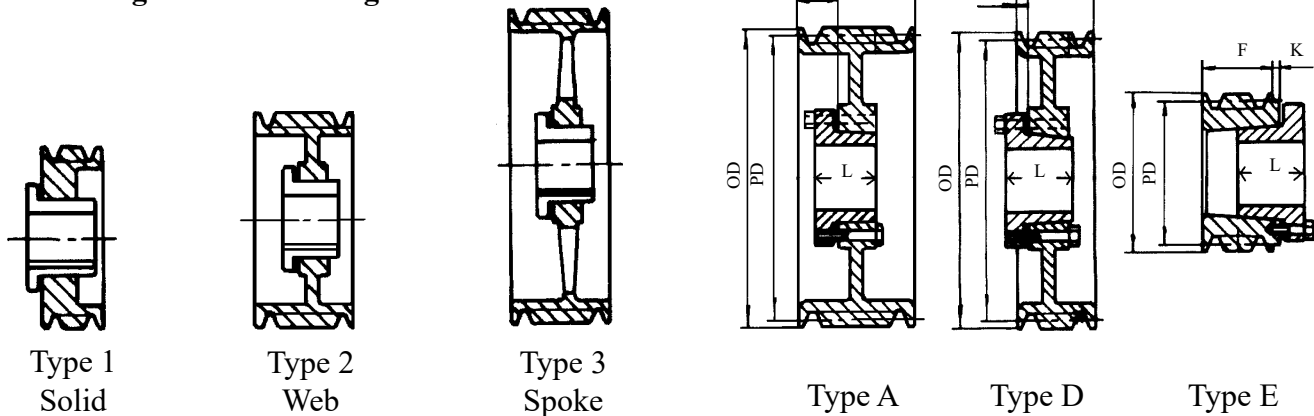

| O.D. | P.D. | | 3 Groove F = 2 1/2 | | | | | 4 Groove F = 3 1/4 | | | | | | |
|-------|-------|-------|--------------------|------|------|--------|---------|--------------------|----------|------|------|--------|---------|-------|
| | A | B | Part No. | Bush | Type | K | L | WT. | Part No. | Bush | Type | K | L | WT. |
| 3.75 | 3.00 | 3.40 | *3B34SH | SH | E-1 | 0 | 1 5/16 | 3.3 | *+4B34SD | SD | E-1 | 5/16 | 1 13/16 | 4.3 |
| 3.95 | 3.20 | 3.60 | *3B36SH | SH | D-1 | 3/16 | 1 5/16 | 3.6 | *+4B36SD | SD | E-1 | 5/16 | 1 13/16 | 4.8 |
| 4.15 | 3.40 | 3.80 | *3B38SH | SH | D-1 | 3/16 | 1 5/16 | 3.8 | *+4B38SD | SD | E-1 | 5/16 | 1 13/16 | 5.2 |
| 4.35 | 3.60 | 4.00 | +3B40SH | SH | A-1 | 1 1/16 | 1 5/16 | 4.2 | *4B40SD | SD | E-1 | 0 | 1 13/16 | 5.6 |
| 4.55 | 3.80 | 4.20 | +3B42SH | SH | A-1 | 1 1/16 | 1 5/16 | 4.8 | *4B42SD | SD | E-1 | 0 | 1 13/16 | 6.2 |
| 4.75 | 4.00 | 4.40 | 3B44SH | SH | A-1 | 1 1/16 | 1 5/16 | 5.3 | *4B44SD | SD | E-1 | 0 | 1 13/16 | 6.6 |
| 4.95 | 4.20 | 4.60 | +3B46SD | SD | A-1 | 1 1/16 | 1 13/16 | 6.0 | *4B46SD | SD | A-1 | 1 5/16 | 1 13/16 | 7.2 |
| 5.15 | 4.40 | 4.80 | 3B48SD | SD | A-1 | 1 1/16 | 1 13/16 | 6.5 | 4B48SD | SD | A-1 | 1 5/16 | 1 13/16 | 7.9 |
| 5.35 | 4.60 | 5.00 | 3B50SD | SD | A-1 | 1 1/16 | 1 13/16 | 7.2 | 4B50SD | SD | A-1 | 1 5/16 | 1 13/16 | 8.4 |
| 5.55 | 4.80 | 5.20 | 3B52SD | SD | A-1 | 1 1/16 | 1 13/16 | 7.8 | 4B52SD | SD | A-1 | 1 5/16 | 1 13/16 | 9.2 |
| 5.75 | 5.00 | 5.40 | 3B54SD | SD | A-1 | 1 1/16 | 1 13/16 | 8.4 | 4B54SD | SD | A-1 | 1 5/16 | 1 13/16 | 9.8 |
| 5.95 | 5.20 | 5.60 | 3B56SD | SD | A-1 | 1 1/16 | 1 13/16 | 9.0 | 4B56SD | SD | A-1 | 1 5/16 | 1 13/16 | 10.7 |
| 6.15 | 5.40 | 5.80 | 3B58SD | SD | A-1 | 1 1/16 | 1 13/16 | 9.7 | 4B58SD | SD | A-1 | 1 5/16 | 1 13/16 | 11.4 |
| 6.35 | 5.60 | 6.00 | 3B60SD | SD | A-1 | 1 1/16 | 1 13/16 | 8.9 | 4B60SD | SD | A-1 | 1 5/16 | 1 13/16 | 10.9 |
| 6.55 | 5.80 | 6.20 | 3B62SD | SD | A-2 | 1 1/16 | 1 13/16 | 9.4 | 4B62SD | SD | A-2 | 1 5/16 | 1 13/16 | 11.3 |
| 6.75 | 6.00 | 6.40 | 3B64SD | SD | A-2 | 1 1/16 | 1 13/16 | 9.7 | 4B64SD | SD | A-2 | 1 5/16 | 1 13/16 | 11.7 |
| 6.95 | 6.20 | 6.60 | 3B66SD | SD | A-2 | 1 1/16 | 1 13/16 | 10.0 | 4B66SD | SD | A-2 | 1 5/16 | 1 13/16 | 12.2 |
| 7.15 | 6.40 | 6.80 | 3B68SD | SD | A-2 | 1 1/16 | 1 13/16 | 11.1 | 4B68SD | SD | A-2 | 1 5/16 | 1 13/16 | 13.0 |
| 7.35 | 6.60 | 7.00 | 3B70SK | SK | A-2 | 11/16 | 1 15/16 | 11.4 | 4B70SK | SK | A-2 | 1 | 1 15/16 | 13.7 |
| 7.75 | 7.00 | 7.40 | 3B74SK | SK | A-2 | 11/16 | 1 15/16 | 12.5 | 4B74SK | SK | A-2 | 1 | 1 15/16 | 14.8 |
| 8.35 | 7.60 | 8.00 | 3B80SK | SK | A-2 | 11/16 | 1 15/16 | 13.6 | 4B80SK | SK | A-2 | 1 | 1 15/16 | 16.3 |
| 8.95 | 8.20 | 8.60 | 3B86SK | SK | A-3 | 11/16 | 1 15/16 | 14.6 | 4B86SK | SK | A-3 | 1 | 1 15/16 | 17.7 |
| 9.35 | 8.60 | 9.00 | 3B90SK | SK | A-3 | 11/16 | 1 15/16 | 15.9 | 4B90SK | SK | A-3 | 1 | 1 15/16 | 19.0 |
| 9.75 | 9.00 | 9.40 | 3B94SK | SK | A-3 | 11/16 | 1 15/16 | 16.6 | 4B94SK | SK | A-3 | 1 | 1 15/16 | 19.7 |
| 11.35 | 10.60 | 11.00 | 3B110SK | SK | A-3 | 11/16 | 1 15/16 | 20.8 | 4B110SK | SK | A-3 | 1 | 1 15/16 | 25.2 |
| 12.75 | 12.00 | 12.40 | 3B124SK | SK | A-3 | 11/16 | 1 15/16 | 22.5 | 4B124SK | SK | A-3 | 1 | 1 15/16 | 28.4 |
| 13.95 | 13.20 | 13.60 | 3B136SK | SK | A-3 | 11/16 | 1 15/16 | 25.3 | 4B136SK | SK | A-3 | 1 | 1 15/16 | 31.3 |
| 15.75 | 15.00 | 15.40 | 3B154SK | SK | A-3 | 11/16 | 1 15/16 | 29.8 | 4B154SF | SF | A-3 | 1 | 2 1/16 | 37.6 |
| 16.35 | 15.60 | 16.00 | 3B160SK | SK | A-3 | 11/16 | 1 15/16 | 30.3 | 4B160SF | SF | A-3 | 1 | 2 1/16 | 38.6 |
| 18.75 | 18.00 | 18.40 | 3B184SK | SK | A-3 | 11/16 | 1 15/16 | 39.1 | 4B184SF | SF | A-3 | 1 | 2 1/16 | 45.2 |
| 20.35 | 19.60 | 20.00 | 3B200SF | SF | D-3 | 5/8 | 2 1/16 | 43.0 | 4B200SF | SF | A-3 | 1 | 2 1/16 | 52.0 |
| 25.35 | 24.60 | 25.00 | 3B250SF | SF | D-3 | 5/8 | 2 1/16 | 56.0 | 4B250E | E | A-3 | 1 | 2 3/4 | 72.0 |
| 30.35 | 29.60 | 30.00 | 3B300SF | SF | D-3 | 5/8 | 2 1/16 | 77.0 | 4B300E | E | A-3 | 1 | 2 3/4 | 97.0 |
| 38.35 | 37.60 | 38.00 | 3B380E | E | D-3 | 5/8 | 2 3/4 | 115.0 | 4B380E | E | A-3 | 1 | 2 3/4 | 151.1 |

* = Can only be mounted from one direction.

+ = Includes cap screws to be used in place of the ones that come with the bushing.

Note: Cast iron sheaves may not exceed 6500 FPM. This speed **DOES NOT** specify if dynamic balancing (2 plane) is required. Contact customer service to verify whether dynamic balancing is required.

Cast Iron Sheaves - Heavy Duty
Bushed, Five and Six Groove
A-B QD Sheaves
Order part number size
Example: 5B34SD

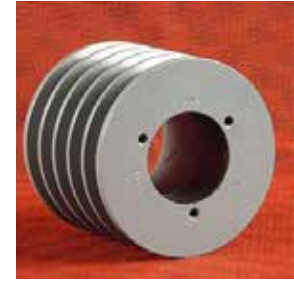

For A, AX, B & BX V-Belts. See pages 102-108.
Order QD bushings separately.
Stock Bushings Located on Pages 84-85.

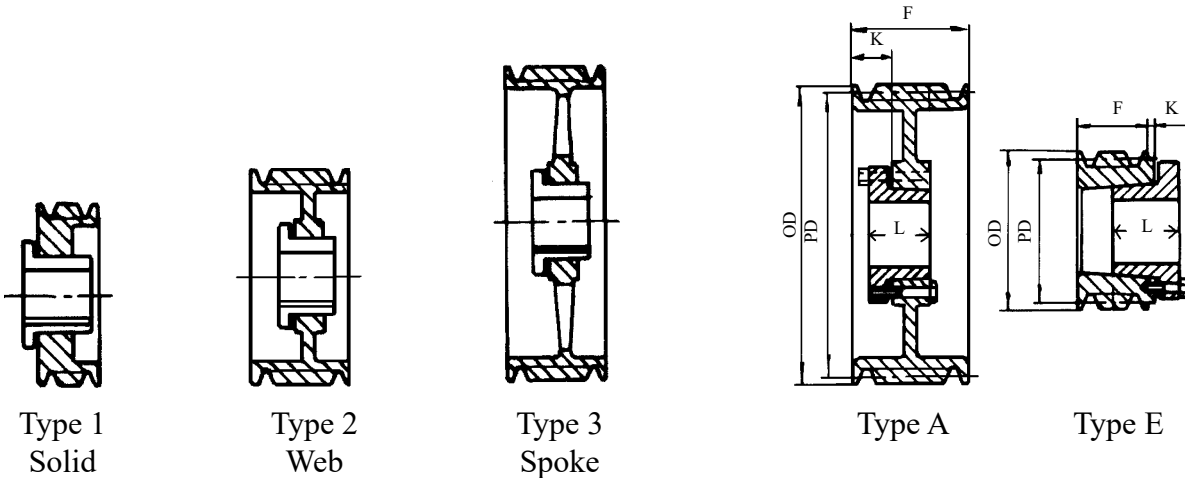

| O.D. | P.D. | | 5 Groove F = 4 | | | | | | 6 Groove F = 4 3/4 | | | | | |
|-------|-------|-------|----------------|------|------|--------|---------|-------|--------------------|------|------|---------|---------|-------|
| | A | B | Part No. | Bush | Type | K | L | WT. | Part No. | Bush | Type | K | L | WT. |
| 3.75 | 3.00 | 3.40 | *+5B34SD | SD | E-1 | 5/16 | 1 13/16 | 5.2 | *+6B34SD | SD | E-1 | 5/16 | 1 13/16 | 5.8 |
| 3.95 | 3.20 | 3.60 | *+5B36SD | SD | E-1 | 5/16 | 1 13/16 | 5.7 | *+6B36SD | SD | E-1 | 5/16 | 1 13/16 | 6.8 |
| 4.15 | 3.40 | 3.80 | *5B38SD | SD | E-1 | 5/16 | 1 13/16 | 6.2 | *6B38SD | SD | E-1 | 5/16 | 1 13/16 | 7.1 |
| 4.35 | 3.60 | 4.00 | *5B40SD | SD | E-1 | 0 | 1 13/16 | 6.5 | *6B40SD | SD | E-1 | 0 | 1 13/16 | 7.7 |
| 4.55 | 3.80 | 4.20 | *5B42SD | SD | E-1 | 0 | 1 13/16 | 7.1 | *6B42SD | SD | E-1 | 0 | 1 13/16 | 8.6 |
| 4.75 | 4.00 | 4.40 | *5B44SD | SD | E-1 | 0 | 1 13/16 | 7.8 | *6B44SD | SD | E-1 | 0 | 1 13/16 | 9.3 |
| 4.95 | 4.20 | 4.60 | +5B46SD | SD | A-1 | 1 5/16 | 1 13/16 | 8.5 | +6B46SD | SD | A-1 | 1 3/16 | 1 13/16 | 9.8 |
| 5.15 | 4.40 | 4.80 | 5B48SD | SD | A-1 | 1 5/16 | 1 13/16 | 9.2 | 6B48SD | SD | A-1 | 1 3/16 | 1 13/16 | 10.8 |
| 5.35 | 4.60 | 5.00 | 5B50SD | SD | A-1 | 1 5/16 | 1 13/16 | 9.9 | 6B50SD | SD | A-1 | 1 3/16 | 1 13/16 | 11.0 |
| 5.55 | 4.80 | 5.20 | 5B52SD | SD | A-1 | 1 5/16 | 1 13/16 | 10.9 | 6B52SD | SD | A-1 | 1 3/16 | 1 13/16 | 12.0 |
| 5.75 | 5.00 | 5.40 | 5B54SK | SK | A-1 | 1 5/16 | 1 15/16 | 10.5 | 6B54SK | SK | A-1 | 1 5/16 | 1 15/16 | 12.5 |
| 5.95 | 5.20 | 5.60 | 5B56SK | SK | A-1 | 1 5/16 | 1 15/16 | 11.4 | 6B56SK | SK | A-1 | 1 5/16 | 1 15/16 | 13.3 |
| 6.15 | 5.40 | 5.80 | 5B58SK | SK | A-1 | 1 5/16 | 1 15/16 | 12.3 | 6B58SK | SK | A-1 | 1 5/16 | 1 15/16 | 14.1 |
| 6.35 | 5.60 | 6.00 | 5B60SK | SK | A-1 | 1 5/16 | 1 15/16 | 12.8 | 6B60SK | SK | A-1 | 1 5/16 | 1 15/16 | 15.4 |
| 6.55 | 5.80 | 6.20 | 5B62SK | SK | A-1 | 1 5/16 | 1 15/16 | 13.6 | 6B62SK | SK | A-1 | 1 5/16 | 1 15/16 | 16.4 |
| 6.75 | 6.00 | 6.40 | 5B64SK | SK | A-1 | 1 5/16 | 1 15/16 | 14.6 | 6B64SK | SK | A-1 | 1 5/16 | 1 15/16 | 17.3 |
| 6.95 | 6.20 | 6.60 | 5B66SK | SK | A-1 | 1 5/16 | 1 15/16 | 15.9 | 6B66SK | SK | A-1 | 1 5/16 | 1 15/16 | 17.9 |
| 7.15 | 6.40 | 6.80 | 5B68SK | SK | A-1 | 1 5/16 | 1 15/16 | 16.7 | 6B68SK | SK | A-1 | 1 5/16 | 1 15/16 | 19.3 |
| 7.35 | 6.60 | 7.00 | 5B70SF | SF | A-1 | 1 5/16 | 2 1/16 | 17.1 | 6B70SF | SF | A-1 | 1 11/16 | 2 1/16 | 19.8 |
| 7.75 | 7.00 | 7.40 | 5B74SF | SF | A-1 | 1 5/16 | 2 1/16 | 18.7 | 6B74SF | SF | A-2 | 1 11/16 | 2 1/16 | 22.4 |
| 8.35 | 7.60 | 8.00 | 5B80SF | SF | A-2 | 1 5/16 | 2 1/16 | 19.3 | 6B80SF | SF | A-2 | 1 11/16 | 2 1/16 | 25.4 |
| 8.95 | 8.20 | 8.60 | 5B86SF | SF | A-2 | 1 5/16 | 2 1/16 | 21.6 | 6B86SF | SF | A-2 | 1 11/16 | 2 1/16 | 25.7 |
| 9.75 | 9.00 | 9.40 | 5B94SF | SF | A-2 | 1 5/16 | 2 1/16 | 24.0 | 6B94SF | SF | A-2 | 1 11/16 | 2 1/16 | 27.9 |
| 11.35 | 10.60 | 11.00 | 5B110SF | SF | A-3 | 1 5/16 | 2 1/16 | 28.7 | 6B110SF | SF | A-3 | 1 11/16 | 2 1/16 | 33.1 |
| 12.75 | 12.00 | 12.40 | 5B124SF | SF | A-3 | 1 5/16 | 2 1/16 | 33.8 | 6B124SF | SF | A-3 | 1 11/16 | 2 1/16 | 37.5 |
| 13.95 | 13.20 | 13.60 | 5B136SF | SF | A-3 | 1 5/16 | 2 1/16 | 37.0 | 6B136SF | SF | A-3 | 1 11/16 | 2 1/16 | 42.0 |
| 15.75 | 15.00 | 15.40 | 5B154SF | SF | A-3 | 1 5/16 | 2 1/16 | 43.0 | 6B154SF | SF | A-3 | 1 11/16 | 2 1/16 | 49.0 |
| 16.35 | 15.60 | 16.00 | 5B160SF | SF | A-3 | 1 5/16 | 2 1/16 | 48.0 | 6B160SF | SF | A-3 | 1 11/16 | 2 1/16 | 48.8 |
| 18.75 | 18.00 | 18.40 | 5B184SF | SF | A-3 | 1 5/16 | 2 1/16 | 51.8 | 6B184SF | SF | A-3 | 1 11/16 | 2 1/16 | 60.0 |
| 20.35 | 19.60 | 20.00 | 5B200E | E | A-3 | 1 1/4 | 2 3/4 | 62.0 | 6B200E | E | A-3 | 1 3/8 | 2 3/4 | 72.0 |
| 25.35 | 24.60 | 25.00 | 5B250E | E | A-3 | 1 1/4 | 2 3/4 | 85.0 | 6B250E | E | A-3 | 1 3/8 | 2 3/4 | 94.0 |
| 30.35 | 29.60 | 30.00 | 5B300E | E | A-3 | 1 1/4 | 2 3/4 | 85.0 | 6B300E | E | A-3 | 1 3/8 | 2 3/4 | 131.0 |
| 38.35 | 37.60 | 38.00 | 5B380E | E | A-3 | 1 1/4 | 2 3/4 | 159.0 | 6B380E | E | A-3 | 1 3/8 | 2 3/4 | 183.0 |

* = Can only be mounted from one direction.

+ = Includes cap screws to be used in place of the ones that come with the bushing.

Note: Cast iron sheaves may not exceed 6500 FPM. This speed **DOES NOT** specify if dynamic balancing (2 plane) is required.

Contact customer service to verify whether dynamic balancing is required.

QD Bushing Sheaves

Cast Iron Sheaves
Bushed, Seven and Eight Groove
A-B QD Sheaves
Order part number size
Example: 7B54SK

For A, AX, B & BX V-Belts. See pages 102-108.
Order QD bushings separately.
Stock Bushings Located on Pages 84-85.

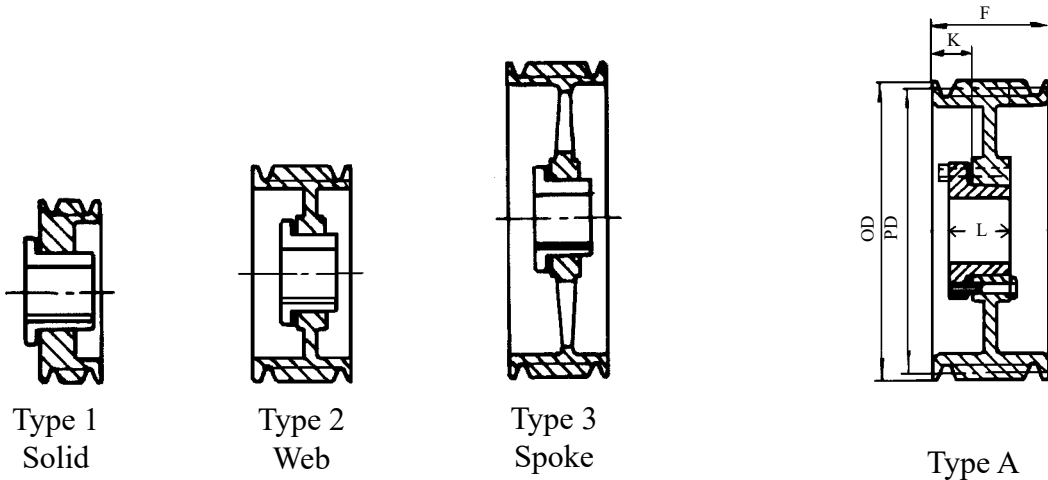

| O.D. | P.D. | | 7 Groove F = 5 1/2 | | | | | | 8 Groove F = 6 1/4 | | | | | |
|-------|-------|-------|--------------------|------|------|---------|---------|------|--------------------|------|------|---------|---------|-------|
| | A | B | Part No. | Bush | Type | K | L | WT. | Part No. | Bush | Type | K | L | WT. |
| 5.75 | 5.00 | 5.40 | 7B54SK | SK | A-1 | 1 13/16 | 1 15/16 | 12.5 | 8B54SK | SK | A-1 | 1 13/16 | 1 15/16 | 15.5 |
| 5.95 | 5.20 | 5.60 | 7B56SK | SK | A-1 | 1 13/16 | 1 15/16 | 13.6 | 8B56SK | SK | A-1 | 1 13/16 | 1 15/16 | 16.6 |
| 6.15 | 5.40 | 5.80 | 7B58SK | SK | A-1 | 1 13/16 | 1 15/16 | 14.1 | 8B58SK | SK | A-1 | 1 13/16 | 1 15/16 | 17.1 |
| 6.35 | 5.60 | 6.00 | 7B60SK | SK | A-1 | 1 13/16 | 1 15/16 | 15.7 | 8B60SK | SK | A-1 | 1 13/16 | 1 15/16 | 18.7 |
| 6.55 | 5.80 | 6.20 | 7B62SF | SF | A-1 | 1 13/16 | 2 1/16 | 16.3 | 8B62SF | SF | A-1 | 1 13/16 | 2 1/16 | 19.3 |
| 6.75 | 6.00 | 6.40 | 7B64SF | SF | A-1 | 1 13/16 | 2 1/16 | 17.3 | 8B64SF | SF | A-1 | 1 13/16 | 2 1/16 | 20.3 |
| 6.95 | 6.20 | 6.60 | 7B66SF | SF | A-1 | 1 13/16 | 2 1/16 | 18.3 | 8B66SF | SF | A-1 | 1 13/16 | 2 1/16 | 21.3 |
| 7.15 | 6.40 | 6.80 | 7B68SF | SF | A-1 | 1 13/16 | 2 1/16 | 19.9 | 8B68SF | SF | A-1 | 1 13/16 | 2 1/16 | 22.9 |
| 7.35 | 6.60 | 7.00 | 7B70SF | SF | A-1 | 1 13/16 | 2 1/16 | 21.7 | 8B70SF | SF | A-1 | 1 13/16 | 2 1/16 | 24.7 |
| 7.75 | 7.00 | 7.40 | 7B74SF | SF | A-1 | 1 13/16 | 2 1/16 | 23.5 | 8B74SF | SF | A-1 | 1 13/16 | 2 1/16 | 26.5 |
| 8.95 | 8.20 | 8.60 | 7B86E | E | A-1 | 2 3/8 | 2 3/4 | 32.3 | 8B86E | E | A-1 | 2 3/8 | 2 3/4 | 35.3 |
| 9.75 | 9.00 | 9.40 | 7B94E | E | A-1 | 2 3/8 | 2 3/4 | 37.9 | 8B94E | E | A-1 | 2 3/8 | 2 3/4 | 41.9 |
| 11.35 | 10.60 | 11.00 | 7B110E | E | A-2 | 2 3/8 | 2 3/4 | 41.9 | 8B110E | E | A-2 | 2 3/8 | 2 3/4 | 44.9 |
| 12.75 | 12.00 | 12.40 | 7B124E | E | A-3 | 2 3/8 | 2 3/4 | 49.0 | 8B124E | E | A-3 | 2 3/8 | 2 3/4 | 52.0 |
| 13.95 | 13.20 | 13.60 | 7B136E | E | A-3 | 2 3/8 | 2 3/4 | 52.0 | 8B136E | E | A-3 | 2 3/8 | 2 3/4 | 55.0 |
| 15.75 | 15.00 | 15.40 | 7B154E | E | A-3 | 2 3/8 | 2 3/4 | 59.0 | 8B154E | E | A-3 | 2 3/8 | 2 3/4 | 61.0 |
| 16.35 | 15.60 | 16.00 | 7B160E | E | A-3 | 2 3/8 | 2 3/4 | 62.0 | 8B160E | E | A-3 | 2 3/8 | 2 3/4 | 64.0 |
| 18.75 | 18.00 | 18.40 | 7B184F | F | A-3 | 1 5/16 | 3 3/4 | 80.0 | 8B184F | F | A-3 | 1 5/16 | 3 3/4 | 82.0 |
| 20.35 | 19.60 | 20.00 | | | | | | | 8B200F | F | A-3 | 1 5/16 | 3 3/4 | 93.0 |
| 25.35 | 24.60 | 25.00 | | | | | | | 8B250F | F | A-3 | 1 5/16 | 3 3/4 | 116.0 |
| 30.35 | 29.60 | 30.00 | | | | | | | 8B300F | F | A-3 | 1 5/16 | 3 3/4 | 157.0 |
| 38.35 | 37.60 | 38.00 | | | | | | | 8B380F | F | A-3 | 1 5/16 | 3 3/4 | 216.0 |

Note: Cast iron sheaves may not exceed 6500 FPM.
This speed **DOES NOT** specify if dynamic balancing
(2 plane) is required. Contact customer service to
verify whether dynamic balancing is required.

Cast Iron Sheaves
Bushed, Ten Groove
A-B QD Sheaves
Order part number size
Example: 10B54SK

For A, AX, B & BX V-Belts. See pages 102-108.
Order QD bushings separately.
Stock Bushings Located on Pages 84-85.

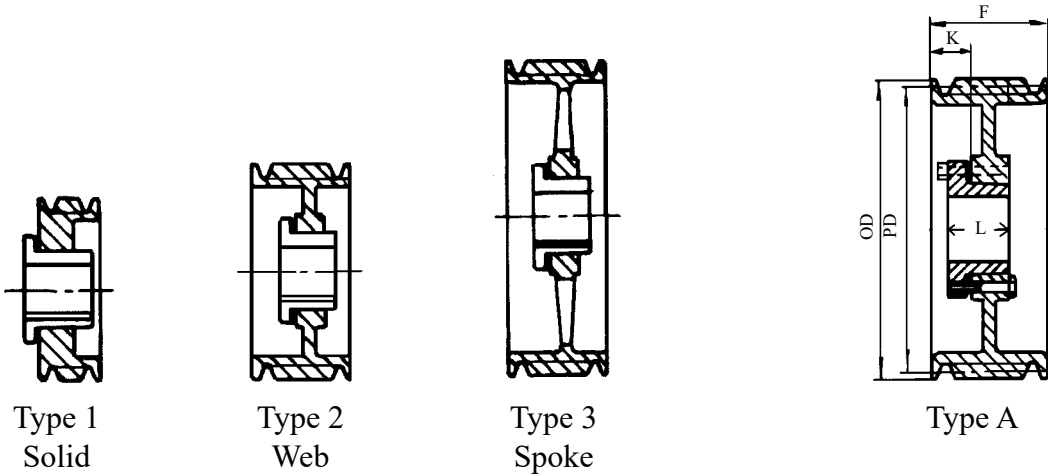

| O.D. | P.D. | | 10 Groove F = 7 3/4 | | | | | WT. |
|-------|-------|-------|---------------------|------|------|--------|---------|-------|
| | A | B | | Bush | Type | K | L | |
| 5.75 | 5.00 | 5.40 | 10B54SK | SK | A-1 | 2 9/16 | 1 15/16 | 18.5 |
| 5.95 | 5.20 | 5.60 | 10B56SK | SK | A-1 | 2 9/16 | 1 15/16 | 19.8 |
| 6.15 | 5.40 | 5.80 | 10B58SK | SK | A-1 | 2 9/16 | 1 15/16 | 21.2 |
| 6.35 | 5.60 | 6.00 | 10B60SK | SK | A-1 | 2 9/16 | 1 15/16 | 22.3 |
| 6.55 | 5.80 | 6.20 | 10B62SF | SF | A-1 | 2 9/16 | 2 1/16 | 22.8 |
| 6.75 | 6.00 | 6.40 | 10B64SF | SF | A-1 | 2 9/16 | 2 1/16 | 24.2 |
| 6.95 | 6.20 | 6.60 | 10B66SF | SF | A-1 | 2 9/16 | 2 1/16 | 25.6 |
| 7.15 | 6.40 | 6.80 | 10B68SF | SF | A-1 | 2 9/16 | 2 1/16 | 26.8 |
| 7.35 | 6.60 | 7.00 | 10B70SF | SF | A-1 | 2 9/16 | 2 1/16 | 28.3 |
| 7.75 | 7.00 | 7.40 | 10B74SF | SF | A-1 | 2 9/16 | 2 1/16 | 31.4 |
| 8.95 | 8.20 | 8.60 | 10B86E | E | A-1 | 3 1/8 | 2 3/4 | 41.0 |
| 9.75 | 9.00 | 9.40 | 10B94E | E | A-2 | 3 1/8 | 2 3/4 | 47.8 |
| 11.35 | 10.60 | 11.00 | 10B110E | E | A-2 | 3 1/8 | 2 3/4 | 58.0 |
| 12.75 | 12.00 | 12.40 | 10B124E | E | A-3 | 3 1/8 | 2 3/4 | 65.0 |
| 13.95 | 13.20 | 13.60 | 10B136F | F | A-3 | 2 1/16 | 3 3/4 | 80.0 |
| 15.75 | 15.00 | 15.40 | 10B154F | F | A-3 | 2 1/16 | 3 3/4 | 87.0 |
| 16.35 | 15.60 | 16.00 | 10B160F | F | A-3 | 2 1/16 | 3 3/4 | 89.0 |
| 18.75 | 18.00 | 18.40 | 10B184F | F | A-3 | 2 1/16 | 3 3/4 | 102.0 |
| 20.35 | 19.60 | 20.00 | 10B200F | F | A-3 | 2 1/16 | 3 3/4 | 112.0 |
| 25.35 | 24.60 | 25.00 | 10B250F | F | A-3 | 2 1/16 | 3 3/4 | 148.0 |
| 30.35 | 29.60 | 30.00 | 10B300F | F | A-3 | 2 1/16 | 3 3/4 | 188.0 |
| 38.35 | 37.60 | 38.00 | 10B380J | J | A-3 | 1 9/16 | 4 5/8 | 291.0 |

Note: Cast iron sheaves may not exceed 6500 FPM.
This speed **DOES NOT** specify if dynamic balancing
(2 plane) is required. Contact customer service to
verify whether dynamic balancing is required.

QD Bushing Sheaves

Cast Iron Sheaves
Bushed, **One and Two Groove**
C QD Sheaves
Order part number size
Example: 1C60SK



For C & CX V-Belts. See pages 109-112.
Order QD bushings separately.
Stock Bushings Located on Pages 84-85.

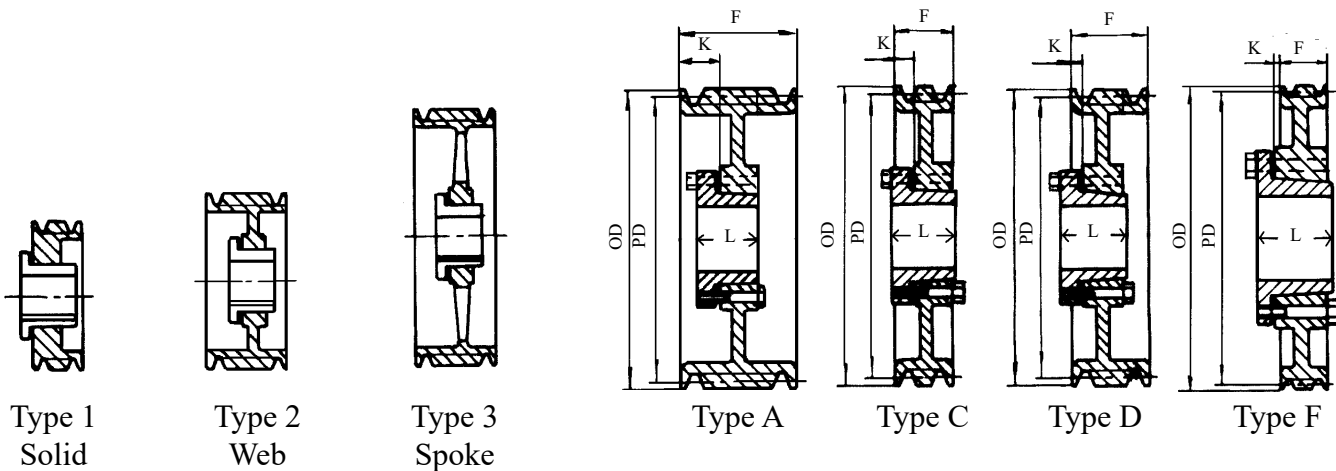

| Diameters | | 1 Groove F = 1 3/8 | | | | | | 2 Groove F = 2 3/8 | | | | | |
|-----------|-------|--------------------|------|------|-----|---------|------|--------------------|------|------|-------|--------|------|
| O.D. | P.D. | Part No. | Bush | Type | K | L | WT. | Part No. | Bush | Type | K | L | WT. |
| 6.40 | 6.00 | 1C60SK | SK | C-1 | 1/8 | 1 15/16 | 8.7 | 2C60SF | SF | A-1 | 7/8 | 2 1/16 | 11.4 |
| 7.40 | 7.00 | 1C70SF | SF | C-1 | 1/8 | 2 1/16 | 9.7 | 2C70SF | SF | A-1 | 13/16 | 2 1/16 | 12.4 |
| 7.90 | 7.50 | 1C75SF | SF | C-1 | 1/8 | 2 1/16 | 11.4 | 2C75SF | SF | A-1 | 13/16 | 2 1/16 | 14.4 |
| 8.40 | 8.00 | 1C80SF | SF | C-1 | 1/8 | 2 1/16 | 13.0 | 2C80SF | SF | A-1 | 13/16 | 2 1/16 | 16.3 |
| 8.90 | 8.50 | 1C85SF | SF | C-2 | 1/8 | 2 1/16 | 12.6 | 2C85SF | SF | A-2 | 13/16 | 2 1/16 | 16.6 |
| 9.40 | 9.00 | 1C90SF | SF | C-2 | 1/8 | 2 1/16 | 12.8 | 2C90SF | SF | A-2 | 13/16 | 2 1/16 | 17.3 |
| 9.90 | 9.50 | 1C95SF | SF | C-2 | 1/8 | 2 1/16 | 13.3 | 2C95SF | SF | A-2 | 13/16 | 2 1/16 | 18.1 |
| 10.40 | 10.00 | 1C100SF | SF | C-2 | 1/8 | 2 1/16 | 14.2 | 2C100SF | SF | A-2 | 13/16 | 2 1/16 | 19.4 |
| 10.90 | 10.50 | 1C105SF | SF | C-3 | 1/8 | 2 1/16 | 15.2 | 2C105SF | SF | A-3 | 13/16 | 2 1/16 | 20.6 |
| 11.40 | 11.00 | 1C110SF | SF | C-3 | 1/8 | 2 1/16 | 16.2 | 2C110SF | SF | A-3 | 13/16 | 2 1/16 | 22.0 |
| 12.40 | 12.00 | 1C120SF | SF | C-3 | 1/8 | 2 1/16 | 18.6 | 2C120SF | SF | D-3 | 9/16 | 2 1/16 | 24.2 |
| 13.40 | 13.00 | 1C130SF | SF | C-3 | 1/8 | 2 1/16 | 19.1 | 2C130SF | SF | D-3 | 9/16 | 2 1/16 | 27.8 |
| 14.40 | 14.00 | 1C140SF | SF | C-3 | 1/8 | 2 1/16 | 20.3 | 2C140SF | SF | D-3 | 9/16 | 2 1/16 | 30.1 |
| 15.40 | 15.00 | 1C150SF | SF | C-3 | 1/8 | 2 1/16 | 22.0 | 2C150SF | SF | D-3 | 9/16 | 2 1/16 | 32.0 |
| 16.40 | 16.00 | 1C160SF | SF | C-3 | 1/8 | 2 1/16 | 23.5 | 2C160SF | SF | D-3 | 9/16 | 2 1/16 | 34.9 |
| 18.40 | 18.00 | 1C180SF | SF | C-3 | 1/8 | 2 1/16 | 27.8 | 2C180SF | SF | D-3 | 9/16 | 2 1/16 | 40.9 |
| 20.40 | 20.00 | 1C200SF | SF | C-3 | 1/8 | 2 1/16 | 31.8 | 2C200SF | SF | D-3 | 9/16 | 2 1/16 | 42.1 |
| 24.40 | 24.00 | 1C240SF | SF | C-3 | 1/8 | 2 1/16 | 41.2 | 2C240SF | SF | D-3 | 9/16 | 2 1/16 | 56.7 |
| 27.40 | 27.00 | | | | | | | 2C270F | F | F-3 | 1/8 | 3 3/4 | 79.4 |
| 30.40 | 30.00 | | | | | | | 2C300F | F | F-3 | 1/8 | 3 3/4 | 82.4 |

Note: Cast iron sheaves may not exceed 6500 FPM.
This speed **DOES NOT** specify if dynamic balancing
(2 plane) is required. Contact customer service to
verify whether dynamic balancing is required.

Cast Iron Sheaves - **Heavy Duty**
Bushed, **Three and Four Groove**
C QD Sheaves
Order part number size
Example: 3C50SD



For C & CX V-Belts. See pages 109-112.
Order QD bushings separately.
Stock Bushings Located on Pages 84-85.

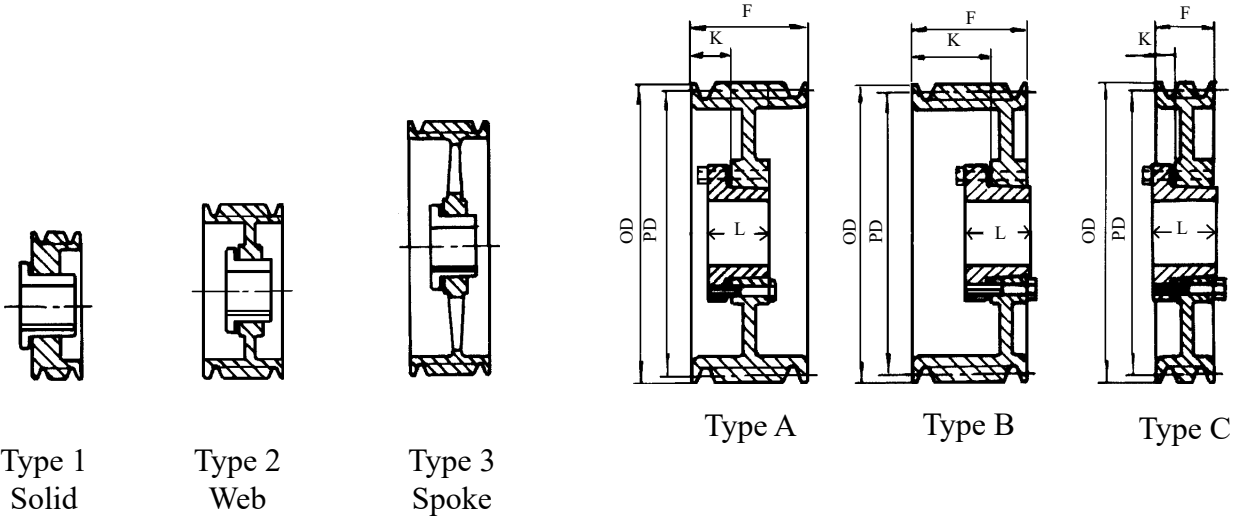

| Diameters | | 3 Groove F = 3 3/8 | | | | | | 4 Groove F = 4 3/8 | | | | | |
|-----------|-------|--------------------|----------|------|--------|---------|-------|--------------------|----------|------|--------|---------|-------|
| O.D. | P.D. | Part No. | Bushing# | Type | K | L | WT. | Part No. | Bushing# | Type | K | L | WT. |
| 5.40 | 5.00 | 3C50SD | SD | A-1 | 1 1/4 | 1 13/16 | 8.4 | 4C50SD | SD | A-1 | 1 1/4 | 1 13/16 | 10.2 |
| 5.40 | 5.00 | ^3C50SK | SK | A-1 | 0 | 1 15/16 | 8.4 | ^4C50SK | SK | A-1 | 0 | 1 15/16 | 10.2 |
| 5.80 | 5.40 | 3C54SD | SD | A-1 | 1 5/16 | 1 13/16 | 10.4 | 4C54SD | SD | A-1 | 1 5/16 | 1 13/16 | 11.8 |
| 5.90 | 5.50 | 3C55SD | SD | A-1 | 1 5/16 | 1 13/16 | 10.9 | 4C55SD | SD | A-1 | 1 5/16 | 1 13/16 | 13.5 |
| 5.90 | 5.50 | | | | | | | ^4C55SK | SK | A-1 | 0 | 1 15/16 | 13.0 |
| 6.00 | 5.60 | 3C56SD | SD | A-1 | 1 5/16 | 1 13/16 | 11.2 | 4C56SD | SD | A-1 | 1 5/16 | 1 13/16 | 13.9 |
| 6.40 | 6.00 | 3C60SF | SF | A-1 | 7/8 | 2 1/16 | 10.1 | 4C60SF | SF | A-1 | 7/8 | 2 1/16 | 12.0 |
| 6.90 | 6.50 | *3C65SF | SF | A-1 | 0 | 2 1/16 | 10.8 | *4C65SF | SF | A-1 | 13/16 | 2 1/16 | 12.2 |
| 7.40 | 7.00 | 3C70SF | SF | A-1 | 1 5/16 | 2 1/16 | 15.9 | 4C70SF | SF | A-1 | 1 9/16 | 2 1/16 | 18.0 |
| 7.90 | 7.50 | 3C75SF | SF | A-1 | 1 5/16 | 2 1/16 | 18.0 | 4C75SF | SF | A-1 | 1 9/16 | 2 1/16 | 20.5 |
| 8.40 | 8.00 | 3C80E | E | B-1 | 1 3/4 | 2 3/4 | 20.9 | 4C80E | E | A-1 | 2 | 2 3/4 | 24.0 |
| 8.90 | 8.50 | 3C85E | E | B-1 | 1 3/4 | 2 3/4 | 24.5 | 4C85E | E | A-1 | 2 | 2 3/4 | 27.3 |
| 9.40 | 9.00 | 3C90E | E | B-1 | 1 3/4 | 2 3/4 | 27.1 | 4C90E | E | A-1 | 2 | 2 3/4 | 30.7 |
| 9.90 | 9.50 | 3C95E | E | B-1 | 1 3/4 | 2 3/4 | 29.1 | 4C95E | E | A-1 | 2 | 2 3/4 | 34.9 |
| 10.40 | 10.00 | 3C100E | E | B-2 | 1 3/4 | 2 3/4 | 30.1 | 4C100E | E | A-2 | 2 | 2 3/4 | 38.1 |
| 10.90 | 10.50 | 3C105E | E | B-2 | 1 3/4 | 2 3/4 | 30.8 | 4C105E | E | A-2 | 2 | 2 3/4 | 35.8 |
| 11.40 | 11.00 | 3C110E | E | B-3 | 1 3/4 | 2 3/4 | 32.9 | 4C110E | E | A-3 | 2 | 2 3/4 | 38.4 |
| 12.40 | 12.00 | 3C120E | E | B-3 | 1 3/4 | 2 3/4 | 38.4 | 4C120E | E | A-3 | 2 | 2 3/4 | 43.6 |
| 13.40 | 13.00 | 3C130E | E | B-3 | 1 3/4 | 2 3/4 | 42.4 | 4C130E | E | A-3 | 2 | 2 3/4 | 49.4 |
| 14.40 | 14.00 | 3C140E | E | B-3 | 1 3/4 | 2 3/4 | 41.7 | 4C140E | E | A-3 | 2 | 2 3/4 | 50.7 |
| 15.40 | 15.00 | 3C150E | E | B-3 | 1 3/4 | 2 3/4 | 45.0 | 4C150E | E | A-3 | 2 | 2 3/4 | 52.0 |
| 16.40 | 16.00 | 3C160E | E | B-3 | 1 3/4 | 2 3/4 | 49.8 | 4C160E | E | A-3 | 2 | 2 3/4 | 60.2 |
| 18.40 | 18.00 | 3C180E | E | B-3 | 1 3/4 | 2 3/4 | 58.6 | 4C180E | E | A-3 | 2 | 2 3/4 | 68.6 |
| 20.40 | 20.00 | 3C200E | E | A-3 | 1 | 2 3/4 | 62.6 | 4C200E | E | A-3 | 1 1/2 | 2 3/4 | 76.9 |
| 24.40 | 24.00 | 3C240E | E | A-3 | 1 | 2 3/4 | 78.7 | 4C240F | F | A-3 | 1 5/16 | 3 3/4 | 100.4 |
| 27.40 | 27.00 | 3C270F | F | C-3 | 7/8 | 3 3/4 | 103.0 | 4C270F | F | A-3 | 1 5/16 | 3 3/4 | 116.8 |
| 30.40 | 30.00 | 3C300F | F | C-3 | 7/8 | 3 3/4 | 115.4 | 4C300F | F | A-3 | 1 5/16 | 3 3/4 | 136.1 |
| 36.40 | 36.00 | 3C360F | F | C-3 | 7/8 | 3 3/4 | 161.7 | 4C360F | F | A-3 | 1 5/16 | 3 3/4 | 194.2 |
| 44.40 | 44.00 | 3C440F | F | C-3 | 13/16 | 3 3/4 | 242.8 | 4C440J | J | A-3 | 1 9/16 | 4 5/8 | 270.4 |
| 50.40 | 50.00 | 3C500F | F | C-3 | 13/16 | 3 3/4 | 275.0 | 4C500J | J | A-3 | 1 9/16 | 4 5/8 | 337.4 |

Note: Cast iron sheaves may not exceed 6500 FPM.

This speed **DOES NOT** specify if dynamic balancing (2 plane) is required. Contact customer service to verify whether dynamic balancing is required.

* = Can only be mounted from one direction.

^ = Small O.D. sheaves used heavily in the oil industry. **25**
Can only be mounted from one direction.

QD Bushing Sheaves

Cast Iron Sheaves - **Heavy Duty**
Bushed, **Five and Six Groove**
C QD Sheaves
Order part number size
Example: 5C60SF

For C & CX V-Belts. See pages 109-112.
Order QD bushings separately.
Stock Bushings Located on Pages 84-85.

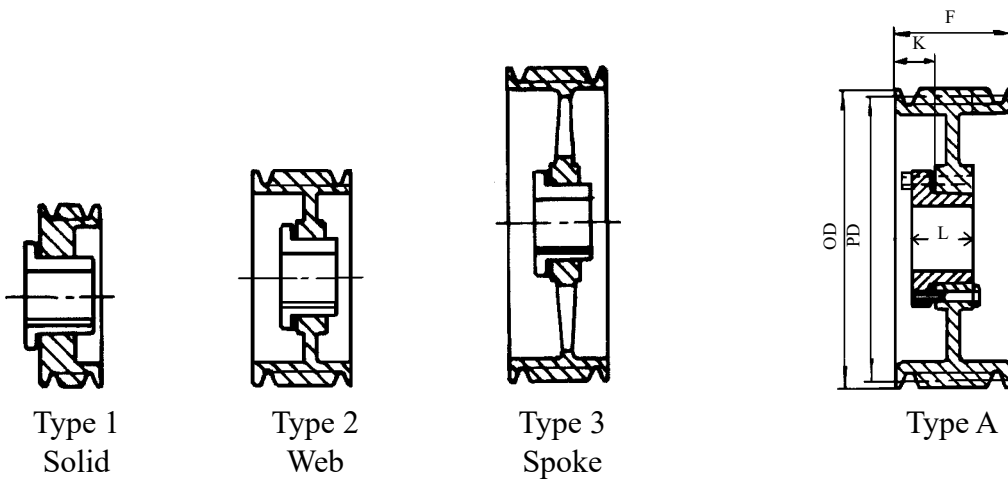

| Diameters | | 5 Groove F = 5 3/8 | | | | | | 6 Groove F = 6 3/8 | | | | | |
|-----------|-------|---------------------|------|------|---------|---------|-------|---------------------|------|------|---------|---------|-------|
| O.D. | P.D. | Part No. | Bush | Type | K | L | WT. | Part No. | Bush | Type | K | L | WT. |
| 5.40 | 5.00 | [^] 5C50SK | SK | A-1 | 7/8 | 1 15/16 | 10.0 | [^] 6C50SK | SK | A-1 | 7/8 | 1 15/16 | 11.0 |
| 6.40 | 6.00 | 5C60SF | SF | A-1 | 7/8 | 2 1/16 | 12.5 | 6C60SF | SF | A-1 | 7/8 | 2 1/16 | 14.0 |
| 7.40 | 7.00 | 5C70SF | SF | A-1 | 1 15/16 | 2 1/16 | 20.8 | 6C70SF | SF | A-1 | 1 15/16 | 2 1/16 | 23.6 |
| 7.90 | 7.50 | 5C75SF | SF | A-1 | 1 15/16 | 2 1/16 | 23.6 | 6C75SF | SF | A-1 | 1 15/16 | 2 1/16 | 26.6 |
| 8.40 | 8.00 | 5C80E | E | A-1 | 2 3/8 | 2 3/4 | 27.3 | 6C80E | E | A-1 | 2 3/8 | 2 3/4 | 30.6 |
| 8.90 | 8.50 | 5C85E | E | A-1 | 2 3/8 | 2 3/4 | 30.8 | 6C85E | E | A-1 | 2 3/8 | 2 3/4 | 34.4 |
| 9.40 | 9.00 | 5C90E | E | A-1 | 2 3/8 | 2 3/4 | 34.5 | 6C90F | F | A-1 | 1 7/16 | 3 3/4 | 43.0 |
| 9.90 | 9.50 | 5C95E | E | A-1 | 2 3/8 | 2 3/4 | 39.1 | 6C95F | F | A-1 | 1 7/16 | 3 3/4 | 49.1 |
| 10.40 | 10.00 | 5C100E | E | A-2 | 2 3/8 | 2 3/4 | 42.4 | 6C100F | F | A-1 | 1 7/16 | 3 3/4 | 54.0 |
| 10.90 | 10.50 | 5C105E | E | A-2 | 2 3/8 | 2 3/4 | 40.4 | 6C105F | F | A-1 | 1 7/16 | 3 3/4 | 60.0 |
| 11.40 | 11.00 | 5C110E | E | A-3 | 2 3/8 | 2 3/4 | 43.1 | 6C110F | F | A-2 | 1 7/16 | 3 3/4 | 66.2 |
| 12.40 | 12.00 | 5C120E | E | A-3 | 2 3/8 | 2 3/4 | 48.8 | 6C120F | F | A-2 | 1 7/16 | 3 3/4 | 62.5 |
| 13.40 | 13.00 | 5C130E | E | A-3 | 2 3/8 | 2 3/4 | 55.1 | 6C130F | F | A-3 | 1 7/16 | 3 3/4 | 70.0 |
| 14.40 | 14.00 | 5C140E | E | A-3 | 2 3/8 | 2 3/4 | 57.2 | 6C140F | F | A-3 | 1 7/16 | 3 3/4 | 73.0 |
| 15.40 | 15.00 | 5C150E | E | A-3 | 2 3/8 | 2 3/4 | 68.2 | 6C150F | F | A-3 | 1 7/16 | 3 3/4 | 75.0 |
| 16.40 | 16.00 | 5C160E | E | A-3 | 2 3/8 | 2 3/4 | 71.2 | 6C160F | F | A-3 | 1 7/16 | 3 3/4 | 87.7 |
| 18.40 | 18.00 | 5C180E | E | A-3 | 2 3/8 | 2 3/4 | 79.1 | 6C180F | F | A-3 | 1 7/16 | 3 3/4 | 98.3 |
| 20.40 | 20.00 | 5C200F | F | A-3 | 1 5/16 | 3 3/4 | 96.5 | 6C200F | F | A-3 | 1 15/16 | 3 3/4 | 109.8 |
| 24.40 | 24.00 | 5C240F | F | A-3 | 1 5/16 | 3 3/4 | 106.7 | 6C240F | F | A-3 | 1 15/16 | 3 3/4 | 122.1 |
| 27.40 | 27.00 | 5C270F | F | A-3 | 1 5/16 | 3 3/4 | 129.2 | 6C270J | J | A-3 | 1 9/16 | 4 5/8 | 158.8 |
| 30.40 | 30.00 | 5C300F | F | A-3 | 1 5/16 | 3 3/4 | 160.8 | 6C300J | J | A-3 | 1 9/16 | 4 5/8 | 192.8 |
| 36.40 | 36.00 | 5C360J | J | A-3 | 1 9/16 | 4 5/8 | 220.3 | 6C360J | J | A-3 | 1 9/16 | 4 5/8 | 254.5 |
| 44.40 | 44.00 | 5C440J | J | A-3 | 1 9/16 | 4 5/8 | 293.2 | 6C440J | J | A-3 | 1 9/16 | 4 5/8 | 315.0 |
| 50.40 | 50.00 | 5C500J | J | A-3 | 1 9/16 | 4 5/8 | 275.0 | 6C500M | M | A-3 | 1 15/16 | 6 3/4 | 325.0 |

Note: Cast iron sheaves may not exceed 6500 FPM. This speed **DOES NOT** specify if dynamic balancing (2 plane) is required. Contact customer service to verify whether dynamic balancing is required.

[^] = Small O.D. sheaves used heavily in the oil industry.

Cast Iron Sheaves - **Heavy Duty**
Bushed, **Seven and Eight Groove**
C QD Sheaves
Order part number size
Example: 7C70SF

For C & CX V-Belts. See pages 109-112.
Order QD bushings separately.
Stock Bushings Located on Pages 84-85.

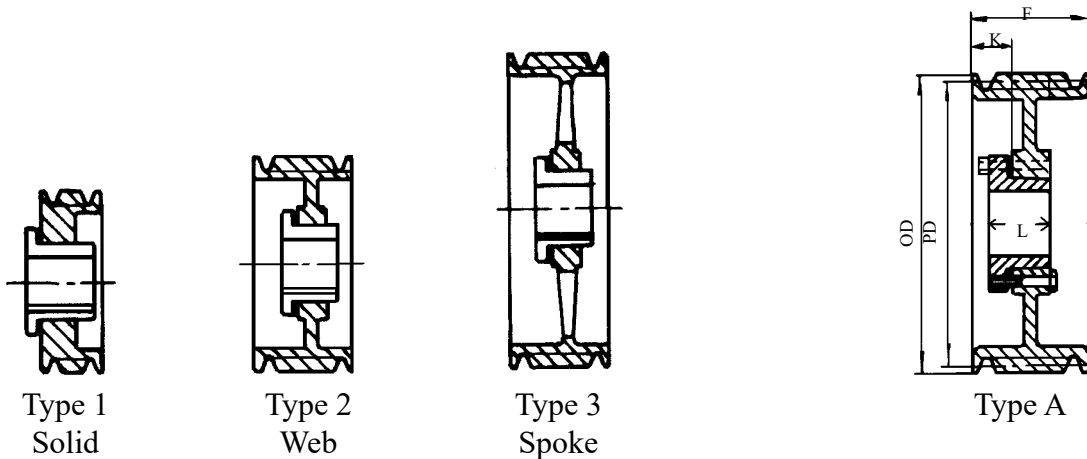

| Diameters | | 7 Groove F = 7 3/8 | | | | | | 8 Groove F = 8 3/8 | | | | | |
|-----------|-------|--------------------|------|------|--------|--------|-------|--------------------|------|------|---------|--------|-------|
| O.D. | P.D. | Part No. | Bush | Type | K | L | WT. | Part No. | Bush | Type | K | L | WT. |
| 7.40 | 7.00 | 7C70SF | SF | A-1 | 3 1/8 | 2 1/16 | 26.2 | 8C70SF | SF | A-1 | 3 1/8 | 2 1/16 | 29.2 |
| 8.40 | 8.00 | 7C80E | E | A-1 | 3 1/4 | 2 3/4 | 34.3 | 8C80E | E | A-1 | 3 1/4 | 2 3/4 | 37.3 |
| 8.90 | 8.50 | 7C85E | E | A-1 | 3 1/4 | 2 3/4 | 38.5 | 8C85E | E | A-1 | 3 1/4 | 2 3/4 | 41.5 |
| 9.40 | 9.00 | 7C90F | F | A-1 | 3 5/16 | 3 3/4 | 47.5 | 8C90F | F | A-1 | 3 5/16 | 3 3/4 | 50.5 |
| 9.90 | 9.50 | 7C95F | F | A-1 | 3 5/16 | 3 3/4 | 54.6 | 8C95F | F | A-1 | 3 5/16 | 3 3/4 | 57.6 |
| 10.40 | 10.00 | 7C100F | F | A-1 | 3 5/16 | 3 3/4 | 59.6 | 8C100F | F | A-1 | 3 5/16 | 3 3/4 | 62.6 |
| 10.90 | 10.50 | 7C105F | F | A-1 | 3 5/16 | 3 3/4 | 66.0 | 8C105F | F | A-1 | 3 5/16 | 3 3/4 | 69.0 |
| 11.40 | 11.00 | 7C110F | F | A-1 | 3 5/16 | 3 3/4 | 72.6 | 8C110F | F | A-1 | 3 5/16 | 3 3/4 | 75.6 |
| 12.40 | 12.00 | 7C120F | F | A-2 | 3 5/16 | 3 3/4 | 69.9 | 8C120F | F | A-2 | 3 5/16 | 3 3/4 | 72.9 |
| 13.40 | 13.00 | 7C130F | F | A-2 | 3 5/16 | 3 3/4 | 78.3 | 8C130F | F | A-2 | 3 5/16 | 3 3/4 | 81.3 |
| 14.40 | 14.00 | 7C140F | F | A-2 | 3 5/16 | 3 3/4 | 85.0 | 8C140F | F | A-2 | 3 5/16 | 3 3/4 | 88.0 |
| 15.40 | 15.00 | 7C150F | F | A-2 | 3 5/16 | 3 3/4 | 103.0 | 8C150F | F | A-2 | 3 5/16 | 3 3/4 | 105.0 |
| 16.40 | 16.00 | 7C160F | F | A-3 | 3 5/16 | 3 3/4 | 107.0 | 8C160F | F | A-3 | 3 5/16 | 3 3/4 | 108.6 |
| 18.40 | 18.00 | 7C180F | F | A-3 | 3 5/16 | 3 3/4 | 121.0 | 8C180F | F | A-3 | 3 5/16 | 3 3/4 | 123.3 |
| 20.40 | 20.00 | | | | | | | 8C200J | J | A-3 | 1 9/16 | 4 5/8 | 146.5 |
| 24.40 | 24.00 | | | | | | | 8C240J | J | A-3 | 1 9/16 | 4 5/8 | 173.4 |
| 27.40 | 27.00 | | | | | | | 8C270J | J | A-3 | 1 9/16 | 4 5/8 | 226.3 |
| 30.40 | 30.00 | | | | | | | 8C300J | J | A-3 | 1 9/16 | 4 5/8 | 240.0 |
| 36.40 | 36.00 | | | | | | | 8C360M | M | A-3 | 1 15/16 | 6 3/4 | 355.3 |
| 44.40 | 44.00 | | | | | | | 8C440M | M | C-3 | 1 15/16 | 6 3/4 | 452.0 |
| 50.40 | 50.00 | | | | | | | 8C500M | M | C-3 | 1 15/16 | 6 3/4 | 546.1 |

Note: Cast iron sheaves may not exceed 6500 FPM.
This speed **DOES NOT** specify if dynamic balancing
(2 plane) is required. Contact customer service to
verify whether dynamic balancing is required.

QD Bushing Sheaves

Cast Iron Sheaves - Heavy Duty
Bushed, Ten Groove
C QD Sheaves
Order part number size
Example: 10C80E

For C & CX V-Belts. See pages 109-112.
Order QD bushings separately.
Stock Bushings Located on Pages 84-85.

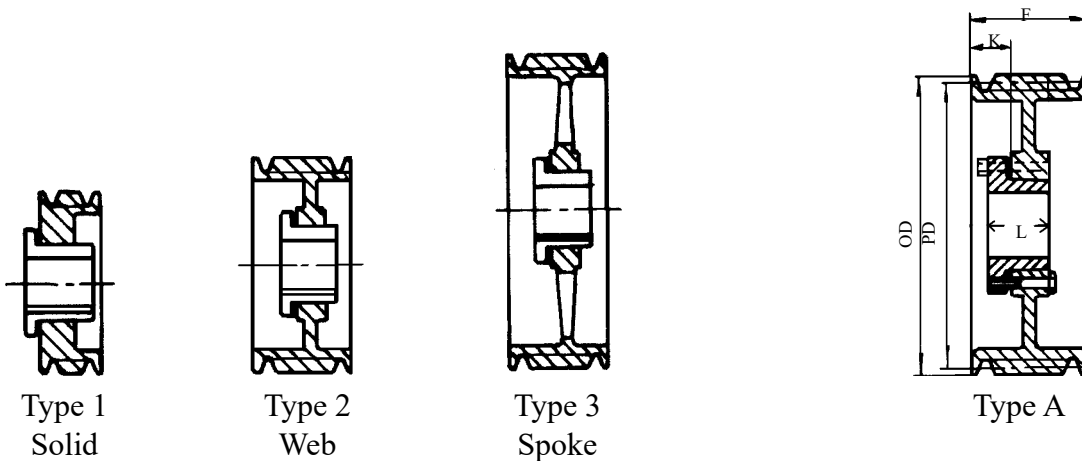

| Diameters | | 10 Groove F = 10 3/8 | | | | | |
|-----------|-------|----------------------|------|------|---------|-------|-------|
| O.D. | P.D. | Part No. | Bush | Type | K | L | WT. |
| 8.40 | 8.00 | 10C80E | E | A-1 | 3 1/4 | 2 3/4 | 43.9 |
| 8.90 | 8.50 | 10C85E | E | A-1 | 3 1/4 | 2 3/4 | 48.6 |
| 9.40 | 9.00 | +10C90J | J | A-1 | 3 9/16 | 4 5/8 | 59.6 |
| 9.90 | 9.50 | +10C95J | J | A-1 | 3 9/16 | 4 5/8 | 67.8 |
| 10.40 | 10.00 | 10C100J | J | A-1 | 3 9/16 | 4 5/8 | 74.1 |
| 10.90 | 10.50 | 10C105J | J | A-1 | 3 9/16 | 4 5/8 | 82.2 |
| 11.40 | 11.00 | 10C110J | J | A-1 | 3 9/16 | 4 5/8 | 90.6 |
| 12.40 | 12.00 | 10C120J | J | A-1 | 3 9/16 | 4 5/8 | 108.4 |
| 13.40 | 13.00 | 10C130J | J | A-2 | 3 9/16 | 4 5/8 | 136.0 |
| 14.40 | 14.00 | 10C140J | J | A-2 | 3 9/16 | 4 5/8 | 110.8 |
| 16.40 | 16.00 | 10C160J | J | A-3 | 3 9/16 | 4 5/8 | 141.3 |
| 18.40 | 18.00 | 10C180J | J | A-3 | 3 9/16 | 4 5/8 | 148.7 |
| 20.40 | 20.00 | 10C200J | J | A-3 | 3 9/16 | 4 5/8 | 169.7 |
| 24.40 | 24.00 | 10C240M | M | A-3 | 3 9/16 | 6 3/4 | 263.1 |
| 30.40 | 30.00 | 10C300M | M | A-3 | 1 15/16 | 6 3/4 | 332.1 |
| 36.40 | 36.00 | 10C360M | M | A-3 | 1 15/16 | 6 3/4 | 397.5 |
| 44.40 | 44.00 | 10C440M | M | A-3 | 1 15/16 | 6 3/4 | 531.8 |
| 50.40 | 50.00 | 10C500M | M | A-3 | 1 15/16 | 6 3/4 | 600.0 |

+ = Includes cap screws to be used in place of the ones that come with the bushing.

Note: Cast iron sheaves may not exceed 6500 FPM. This speed **DOES NOT** specify if dynamic balancing (2 plane) is required. Contact customer service to verify whether dynamic balancing is required.

Cast Iron Sheaves - Heavy Duty

Bushed, **One and Two Groove**

3V QD Sheaves

Order part number size

Example: 1/3V220JA

For 3V & 3VX Belts. See pages 113-114.

Order QD bushings separately.

Stock Bushings Located on Pages 84-85.

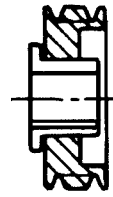

Type 1
Solid

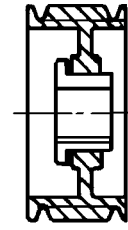

Type 2
Web

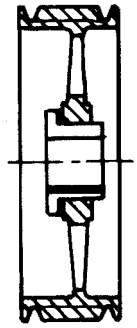

Type 3
Spoke

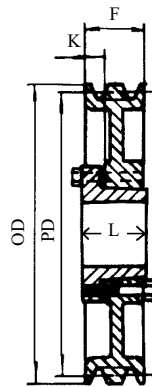

Type C

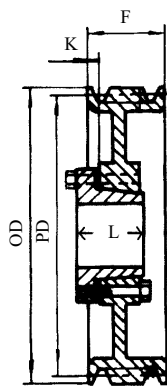

Type D

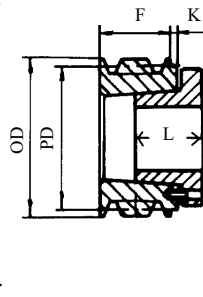

Type E

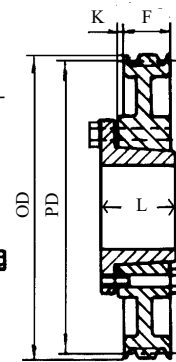

Type F

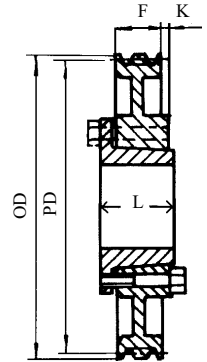

Type G

| Diameters | | 1 Groove F = 11/16 | | | | | | 2 Groove F = 1 3/32 | | | | | |
|-----------|-------|--------------------|------|------|------|---------|------|---------------------|------|------|------|---------|------|
| O.D. | P.D. | Part No. | Bush | Type | K | L | WT. | Part No. | Bush | Type | K | L | WT. |
| 2.20 | 2.15 | *1/3V220JA | JA | E-1 | 7/16 | 1 | .7 | *2/3V220JA | JA | E-1 | 7/16 | 1 | .9 |
| 2.35 | 2.30 | *1/3V235JA | JA | E-1 | 7/16 | 1 | .7 | *2/3V235JA | JA | E-1 | 7/16 | 1 | .9 |
| 2.50 | 2.45 | *1/3V250JA | JA | E-1 | 7/16 | 1 | .8 | *2/3V250JA | JA | E-1 | 7/16 | 1 | 1.0 |
| 2.65 | 2.60 | *1/3V265JA | JA | C-1 | 1/8 | 1 | .6 | *2/3V265JA | JA | D-1 | 1/8 | 1 | .8 |
| 2.80 | 2.75 | 1/3V280JA | JA | C-1 | 1/8 | 1 | .6 | *2/3V280JA | JA | D-1 | 1/8 | 1 | 1.0 |
| 3.00 | 2.95 | 1/3V300JA | JA | C-1 | 1/8 | 1 | .8 | *2/3V300JA | JA | D-1 | 1/8 | 1 | 1.1 |
| 3.15 | 3.10 | 1/3V315JA | JA | C-1 | 1/8 | 1 | .9 | 2/3V315JA | JA | D-1 | 1/8 | 1 | 1.2 |
| 3.35 | 3.30 | 1/3V335JA | JA | C-1 | 1/8 | 1 | 1.1 | *2/3V335SH | SH | D-1 | 9/64 | 1 5/16 | 1.2 |
| 3.65 | 3.60 | 1/3V365SH | SH | G-1 | 1/8 | 1 5/16 | 1.3 | 2/3V365SH | SH | D-1 | 9/64 | 1 5/16 | 1.7 |
| 4.12 | 4.07 | 1/3V412SH | SH | G-1 | 1/8 | 1 5/16 | 1.8 | 2/3V412SH | SH | D-1 | 9/32 | 1 5/16 | 2.3 |
| 4.50 | 4.45 | 1/3V450SH | SH | G-1 | 1/8 | 1 5/16 | 2.2 | 2/3V450SH | SH | D-1 | 9/32 | 1 5/16 | 2.8 |
| 4.75 | 4.70 | 1/3V475SH | SH | G-1 | 1/8 | 1 5/16 | 2.1 | 2/3V475SH | SH | D-1 | 9/32 | 1 5/16 | 2.6 |
| 5.00 | 4.95 | 1/3V500SH | SH | G-1 | 1/8 | 1 5/16 | 2.3 | 2/3V500SH | SH | D-1 | 9/32 | 1 5/16 | 2.9 |
| 5.30 | 5.25 | 1/3V530SH | SH | G-2 | 1/8 | 1 5/16 | 3.0 | 2/3V530SH | SH | D-1 | 9/32 | 1 5/16 | 3.1 |
| 5.60 | 5.55 | 1/3V560SH | SH | G-2 | 1/8 | 1 5/16 | 2.8 | 2/3V560SH | SH | D-2 | 9/32 | 1 5/16 | 3.4 |
| 6.00 | 5.95 | 1/3V600SH | SH | G-2 | 1/8 | 1 5/16 | 3.7 | 2/3V600SH | SH | D-2 | 9/32 | 1 5/16 | 3.8 |
| 6.50 | 6.45 | 1/3V650SH | SH | G-2 | 1/8 | 1 5/16 | 3.4 | 2/3V650SDS | SDS | D-2 | 5/16 | 1 5/16 | 4.5 |
| 6.90 | 6.85 | 1/3V690SH | SH | G-3 | 1/8 | 1 5/16 | 4.1 | 2/3V690SDS | SDS | D-2 | 5/16 | 1 5/16 | 4.7 |
| 8.00 | 7.95 | 1/3V800SDS | SDS | G-3 | 0 | 1 5/16 | 4.8 | 2/3V800SDS | SDS | D-3 | 5/16 | 1 5/16 | 4.8 |
| 10.60 | 10.55 | 1/3V1060SDS | SDS | G-3 | 0 | 1 5/16 | 7.4 | 2/3V1060SK | SK | F-3 | 5/32 | 1 15/16 | 9.6 |
| 14.00 | 13.95 | 1/3V1400SK | SK | G-3 | 7/16 | 1 15/16 | 12.1 | 2/3V1400SK | SK | F-3 | 5/32 | 1 15/16 | 12.6 |
| 19.00 | 18.95 | 1/3V1900SK | SK | G-3 | 7/16 | 1 15/16 | 18.0 | 2/3V1900SK | SK | F-3 | 5/32 | 1 15/16 | 20.6 |
| 25.00 | 24.95 | | | | | | | 2/3V2500SF | SF | E-3 | 1/4 | 2 1/16 | 31.5 |

Note: Cast iron sheaves may not exceed 6500 FPM.
This speed **DOES NOT** specify if dynamic balancing
(2 plane) is required. Contact customer service to
verify whether dynamic balancing is required.

* = Can only be mounted from one direction.

QD Bushing Sheaves

Cast Iron Sheaves - **Heavy Duty**
Bushed, **Three and Four Groove**
3V QD Sheaves

Order part number size
Example: 3/3V250JA

For 3V & 3VX Belts. See pages 113-114.
Order QD bushings separately.
Stock Bushings Located on Pages 84-85.

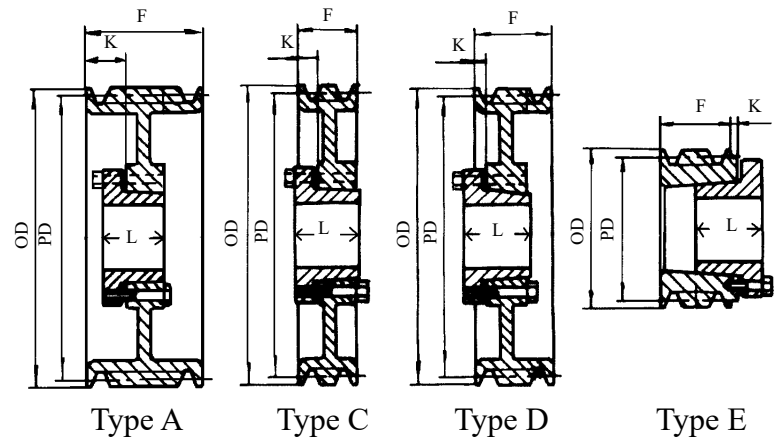
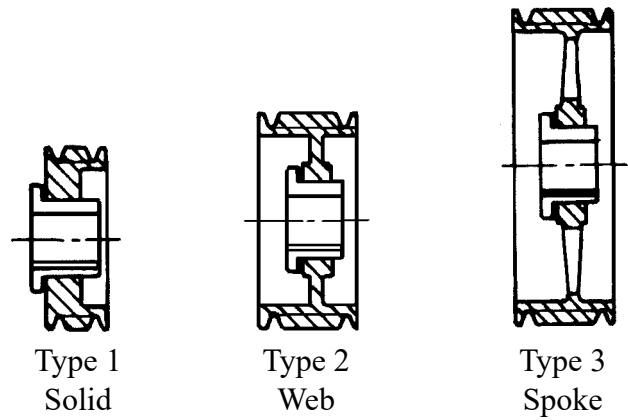

| Diameters | | 3 Groove F = 1 1/2 | | | | | | 4 Groove F = 1 29/32 | | | | | |
|-----------|-------|--------------------|------|------|-------|---------|------|----------------------|------|------|-------|---------|------|
| O.D. | P.D. | Part No. | Bush | Type | K | L | WT. | Part No. | Bush | Type | K | L | WT. |
| 2.50 | 2.45 | *3/3V250JA | JA | E-1 | 7/16 | 1 | 1.2 | | | | | | |
| 2.65 | 2.60 | *3/3V265JA | JA | D-1 | 1/8 | 1 | 1.1 | *4/3V265JA | JA | D-1 | 0 | 1 | 1.4 |
| 2.80 | 2.75 | *3/3V280JA | JA | D-1 | 1/8 | 1 | 1.3 | *4/3V280JA | JA | D-1 | 0 | 1 | 1.7 |
| 3.00 | 2.95 | *+3/3V300SH | SH | E-1 | 5/16 | 1 5/16 | 1.7 | *+4/3V300SH | SH | E-1 | 0 | 1 5/16 | 2.0 |
| 3.15 | 3.10 | *+3/3V315SH | SH | E-1 | 5/16 | 1 5/16 | 1.8 | *+4/3V315SH | SH | E-1 | 0 | 1 5/16 | 2.0 |
| 3.35 | 3.30 | *3/3V335SH | SH | D-1 | 1/8 | 1 5/16 | 1.6 | *4/3V335SH | SH | D-1 | 1/8 | 1 5/16 | 1.9 |
| 3.65 | 3.60 | *3/3V365SH | SH | D-1 | 1/8 | 1 5/16 | 2.0 | *4/3V365SH | SH | D-1 | 1/8 | 1 5/16 | 2.3 |
| 4.12 | 4.07 | 3/3V412SH | SH | A-1 | 11/16 | 1 5/16 | 2.7 | 4/3V412SH | SH | A-1 | 13/16 | 1 5/16 | 3.1 |
| 4.50 | 4.45 | 3/3V450SDS | SDS | A-1 | 11/16 | 1 5/16 | 3.1 | 4/3V450SDS | SDS | A-1 | 13/16 | 1 5/16 | 3.5 |
| 4.75 | 4.70 | 3/3V475SDS | SDS | A-1 | 11/16 | 1 5/16 | 3.6 | 4/3V475SDS | SDS | A-1 | 13/16 | 1 5/16 | 3.7 |
| 5.00 | 4.95 | 3/3V500SDS | SDS | A-1 | 11/16 | 1 5/16 | 4.0 | 4/3V500SDS | SDS | A-1 | 13/16 | 1 5/16 | 4.3 |
| 5.30 | 5.25 | 3/3V530SDS | SDS | A-1 | 11/16 | 1 5/16 | 3.9 | 4/3V530SDS | SDS | A-1 | 13/16 | 1 5/16 | 5.0 |
| 5.60 | 5.55 | 3/3V560SDS | SDS | A-1 | 11/16 | 1 5/16 | 4.4 | 4/3V560SDS | SDS | A-1 | 13/16 | 1 5/16 | 5.5 |
| 6.00 | 5.95 | 3/3V600SDS | SDS | A-2 | 11/16 | 1 5/16 | 4.9 | 4/3V600SK | SK | D-1 | 5/8 | 1 15/16 | 7.0 |
| 6.50 | 6.45 | 3/3V650SDS | SDS | A-2 | 11/16 | 1 5/16 | 5.8 | 4/3V650SK | SK | D-2 | 5/8 | 1 15/16 | 7.3 |
| 6.90 | 6.85 | 3/3V690SDS | SDS | A-2 | 11/16 | 1 5/16 | 5.9 | 4/3V690SK | SK | D-2 | 5/8 | 1 15/16 | 8.2 |
| 8.00 | 7.95 | 3/3V800SK | SK | C-3 | 1/4 | 1 15/16 | 8.2 | 4/3V800SK | SK | D-3 | 5/8 | 1 15/16 | 9.4 |
| 10.60 | 10.55 | 3/3V1060SK | SK | C-3 | 1/4 | 1 15/16 | 12.0 | 4/3V1060SK | SK | D-3 | 5/8 | 1 15/16 | 13.4 |
| 14.00 | 13.95 | 3/3V1400SK | SK | C-3 | 1/4 | 1 15/16 | 14.8 | 4/3V1400SK | SK | D-3 | 5/8 | 1 15/16 | 18.3 |
| 19.00 | 18.95 | 3/3V1900SF | SF | C-3 | 1/4 | 2 1/16 | 26.0 | 4/3V1900SF | SF | C-3 | 21/32 | 2 1/16 | 29.7 |
| 25.00 | 24.95 | 3/3V2500SF | SF | C-3 | 1/4 | 2 1/16 | 42.0 | 4/3V2500SF | SF | C-3 | 21/32 | 2 1/16 | 44.0 |
| 33.50 | 33.45 | 3/3V3350SF | SF | C-3 | 1/4 | 2 1/16 | 70.8 | 4/3V3350E | E | C-3 | 9/32 | 2 3/4 | 78.0 |

* = Can only be mounted from one direction.

+ = Includes cap screws to be used in place of the ones that come with the bushing.

Note: Cast iron sheaves may not exceed 6500 FPM. This speed **DOES NOT** specify if dynamic balancing (2 plane) is required. Contact customer service to verify whether dynamic balancing is required.

Cast Iron Sheaves - Heavy Duty
Bushed, Five, Six, Seven and Eight Groove
Order part number size
Example: 5/3V475SDS

For 3V & 3VX Belts. See pages 113-114.
Order QD bushings separately.
Stock Bushings Located on Pages 84-85.

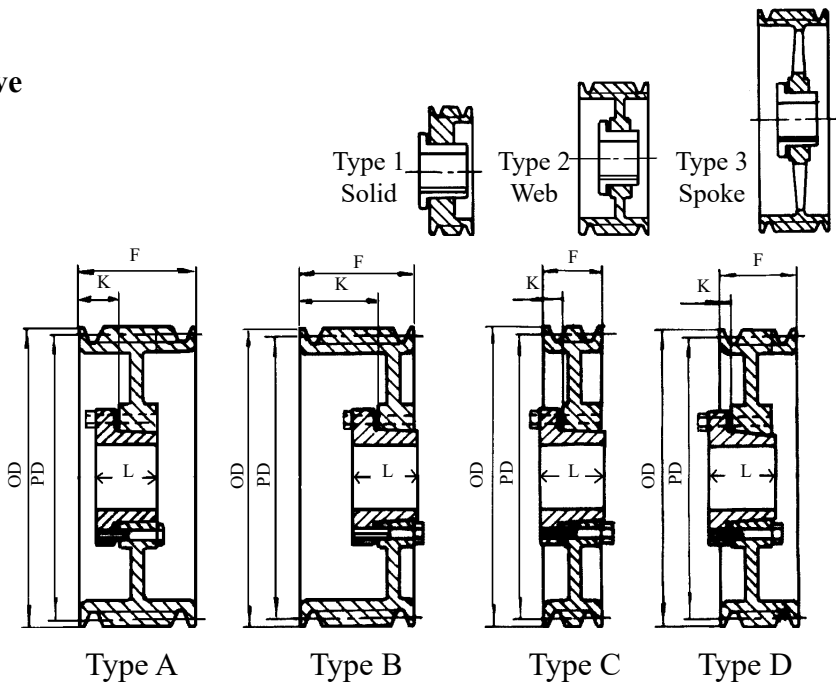

| Diameters | | 5 Groove F = 2 5/16 | | | | | | 6 Groove F = 2 23/32 | | | | | |
|-----------|-------|---------------------|------|------|--------|---------|------|----------------------|------|------|--------|---------|-------|
| O.D. | P.D. | Part No. | Bush | Type | K | L | WT. | Part No. | Bush | Type | K | L | WT. |
| 4.75 | 4.70 | 5/3V475SDS | SDS | A-1 | 13/16 | 1 15/16 | 4.3 | *6/3V475SK | SK | D-1 | 0 | 1 15/16 | 5.0 |
| 5.00 | 4.95 | 5/3V500SDS | SDS | A-1 | 13/16 | 1 15/16 | 4.8 | 6/3V500SK | SK | D-1 | 0 | 1 15/16 | 5.7 |
| 5.30 | 5.25 | 5/3V530SK | SK | A-1 | 15/16 | 1 15/16 | 5.9 | 6/3V530SK | SK | A-1 | 1 5/16 | 1 15/16 | 6.7 |
| 5.60 | 5.55 | 5/3V560SK | SK | A-1 | 15/16 | 1 15/16 | 6.8 | 6/3V560SK | SK | A-1 | 1 5/16 | 1 15/16 | 7.5 |
| 6.00 | 5.95 | 5/3V600SK | SK | A-1 | 15/16 | 1 15/16 | 8.0 | 6/3V600SK | SK | A-1 | 1 5/16 | 1 15/16 | 8.8 |
| 6.50 | 6.45 | 5/3V650SK | SK | A-1 | 15/16 | 1 15/16 | 8.1 | 6/3V650SK | SK | A-1 | 1 5/16 | 1 15/16 | 9.3 |
| 6.90 | 6.85 | 5/3V690SK | SK | A-2 | 15/16 | 1 15/16 | 9.2 | 6/3V690SK | SK | A-2 | 1 5/16 | 1 15/16 | 10.0 |
| 8.00 | 7.95 | 5/3V800SK | SK | A-2 | 15/16 | 1 15/16 | 10.8 | 6/3V800SK | SK | A-2 | 1 5/16 | 1 15/16 | 11.7 |
| 10.60 | 10.55 | 5/3V1060SK | SK | A-2 | 15/16 | 1 15/16 | 15.3 | 6/3V1060SF | SF | A-2 | 7/8 | 2 1/16 | 19.1 |
| 14.00 | 13.95 | 5/3V1400SF | SF | A-3 | 7/8 | 2 1/16 | 23.4 | 6/3V1400SF | SF | A-3 | 7/8 | 2 1/16 | 24.2 |
| 19.00 | 18.95 | 5/3V1900SF | SF | A-3 | 7/8 | 2 1/16 | 37.6 | 6/3V1900E | E | B-3 | 1 3/32 | 2 3/4 | 39.5 |
| 25.00 | 24.95 | 5/3V2500E | E | C-3 | 11/16 | 2 3/4 | 53.0 | 6/3V2500E | E | B-3 | 1 3/32 | 2 3/4 | 65.7 |
| 33.50 | 33.45 | 5/3V3350E | E | C-3 | 11/16 | 2 3/4 | 87.0 | 6/3V3350E | E | B-3 | 1 3/32 | 2 3/4 | 80.0 |
| Diameters | | 7 Groove F = 3 1/8 | | | | | | 8 Groove F = 3 17/32 | | | | | |
| O.D. | P.D. | Part No. | Bush | Type | K | L | WT. | Part No. | Bush | Type | K | L | WT. |
| 4.75 | 4.70 | *7/3V475SK | SK | D-1 | 1/8 | 1 15/16 | 3.8 | *8/3V475SK | SK | D-1 | 1/8 | 1 15/16 | 5.8 |
| 5.00 | 4.95 | *7/3V500SK | SK | D-1 | 1/8 | 1 15/16 | 4.8 | *8/3V500SK | SK | D-1 | 1/8 | 1 15/16 | 6.8 |
| 5.30 | 5.25 | 7/3V530SK | SK | A-1 | 1 5/16 | 1 15/16 | 5.6 | 8/3V530SK | SK | A-1 | 1 5/16 | 1 15/16 | 7.6 |
| 5.60 | 5.55 | 7/3V560SK | SK | A-1 | 1 5/16 | 1 15/16 | 6.7 | 8/3V560SK | SK | A-1 | 1 5/16 | 1 15/16 | 8.7 |
| 6.00 | 5.95 | 7/3V600SK | SK | A-1 | 1 5/16 | 1 15/16 | 8.3 | 8/3V600SK | SK | A-1 | 1 5/16 | 1 15/16 | 10.3 |
| 6.50 | 6.45 | 7/3V650SK | SK | A-1 | 1 5/16 | 1 15/16 | 8.7 | 8/3V650SK | SK | A-1 | 1 5/16 | 1 15/16 | 10.7 |
| 6.90 | 6.85 | 7/3V690SK | SK | A-2 | 1 5/16 | 1 15/16 | 9.8 | 8/3V690SK | SK | A-2 | 1 5/16 | 1 15/16 | 11.8 |
| 8.00 | 7.95 | 7/3V800SF | SF | A-2 | 1 1/8 | 2 1/16 | 13.5 | 8/3V800SF | SF | A-2 | 1 1/8 | 2 1/16 | 15.5 |
| 10.60 | 10.55 | 7/3V1060SF | SF | A-2 | 1 1/8 | 2 1/16 | 18.9 | 8/3V1060SF | SF | A-2 | 1 1/8 | 2 1/16 | 21.9 |
| 14.00 | 13.95 | 7/3V1400E | E | A-3 | 1 1/4 | 2 3/4 | 31.4 | 8/3V1400E | E | A-3 | 1 1/4 | 2 3/4 | 33.4 |
| 19.00 | 18.95 | 7/3V1900E | E | A-3 | 1 1/4 | 2 3/4 | 45.2 | 8/3V1900E | E | A-3 | 1 1/4 | 2 3/4 | 47.2 |
| 25.00 | 24.95 | | | | | | | 8/3V2500E | E | A-3 | 1 1/4 | 2 3/4 | 67.8 |
| 33.50 | 33.45 | | | | | | | 8/3V3350F | F | B-3 | 1 1/32 | 3 3/4 | 112.0 |

Note: Cast iron sheaves may not exceed 6500 FPM. * = Can only be mounted from one direction.
This speed **DOES NOT** specify if dynamic balancing (2 plane) is required. Contact customer service to verify whether dynamic balancing is required.

QD Bushing Sheaves

Cast Iron Sheaves - **Heavy Duty**

Bushed, **Ten Groove**

Order part number size

Example: 10/3V475SK

For 3V & 3VX Belts. See pages 113-114.

Order QD bushings separately.

Stock Bushings Located on Pages 84-85.

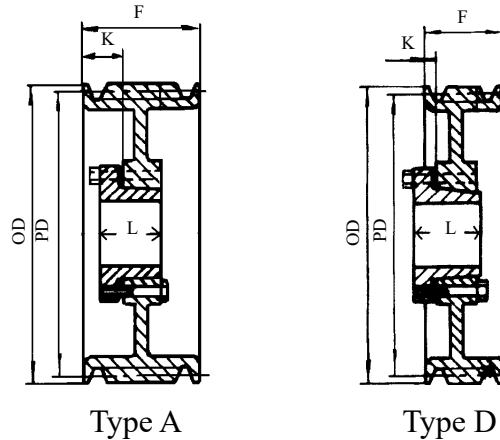
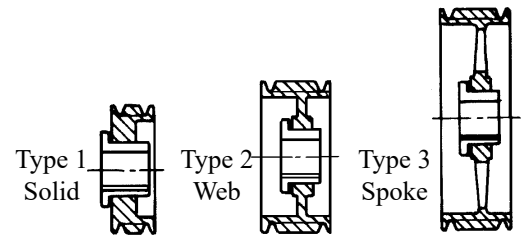

| Diameters | | 10 Groove F = 4 11/32 | | | | | |
|-----------|-------|-----------------------|------|------|--------|---------|-------|
| O.D. | P.D. | Part No. | Bush | Type | K | L | WT. |
| 4.75 | 4.70 | *10/3V475SK | SK | D-1 | 1/8 | 1 15/16 | 6.9 |
| 5.00 | 4.95 | *10/3V500SK | SK | D-1 | 1/8 | 1 15/16 | 8.1 |
| 5.30 | 5.25 | 10/3V530SK | SK | A-1 | 1 7/16 | 1 15/16 | 8.8 |
| 5.60 | 5.55 | 10/3V560SK | SK | A-1 | 1 7/16 | 1 15/16 | 10.1 |
| 6.00 | 5.95 | 10/3V600SK | SK | A-1 | 1 7/16 | 1 15/16 | 13.8 |
| 6.50 | 6.45 | 10/3V650SK | SK | A-1 | 1 7/16 | 1 15/16 | 13.7 |
| 6.90 | 6.85 | 10/3V690SK | SK | A-2 | 1 7/16 | 1 15/16 | 14.1 |
| 8.00 | 7.95 | 10/3V800SF | SF | A-2 | 1 1/2 | 2 1/16 | 18.1 |
| 10.60 | 10.55 | 10/3V1060E | E | A-3 | 1 1/4 | 2 3/4 | 29.2 |
| 14.00 | 13.95 | 10/3V1400E | E | A-3 | 1 1/4 | 2 3/4 | 37.0 |
| 19.00 | 18.95 | 10/3V1900E | E | A-3 | 1 1/4 | 2 3/4 | 54.0 |
| 25.00 | 24.95 | 10/3V2500F | F | A-3 | 1 5/16 | 3 3/4 | 90.0 |
| 33.50 | 33.45 | 10/3V3350F | F | A-3 | 1 5/16 | 3 3/4 | 178.0 |

* = Can only be mounted from one direction.

Note: Cast iron sheaves may not exceed 6500 FPM.
This speed **DOES NOT** specify if dynamic balancing
(2 plane) is required. Contact customer service to
verify whether dynamic balancing is required.

Cast Iron Sheaves - Heavy Duty
Bushed, Two and Three Groove
5V QD Sheaves
Order part number size
Example: 2/5V440SH

For 5V & 5VX Belts
See pages 113, 115 & 116.
Order QD bushings separately.
Stock Bushings Located on Pages 84-85.

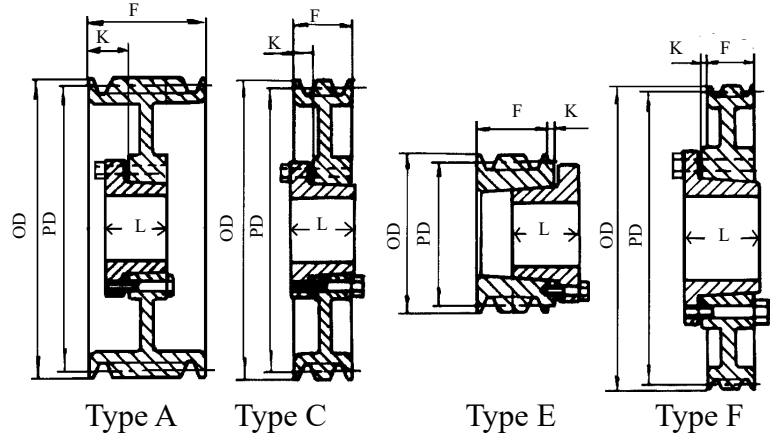
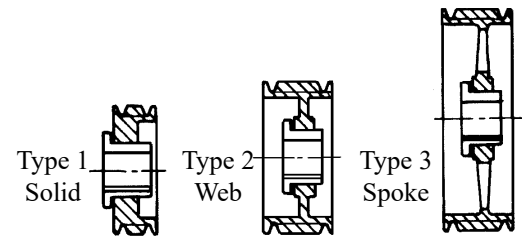

| Diameters | | 2 Groove F = 1 11/16 | | | | | | 3 Groove F = 2 3/8 | | | | | |
|-----------|-------|----------------------|------|------|-------|---------|------|--------------------|------|------|--------|---------|-------|
| O.D. | P.D. | Part No. | Bush | Type | K | L | WT. | Part No. | Bush | Type | K | L | WT. |
| 4.40 | 4.30 | *2/5V440SH | SH | A-1 | 11/16 | 1 5/16 | 3.3 | *3/5V440SDS | SDS | E-1 | 0 | 1 5/16 | 4.2 |
| 4.65 | 4.55 | *2/5V465SDS | SDS | E-1 | 3/16 | 1 5/16 | 3.7 | *3/5V465SDS | SDS | E-1 | 0 | 1 5/16 | 4.7 |
| 4.90 | 4.80 | 2/5V490SDS | SDS | A-1 | 11/16 | 1 5/16 | 3.9 | 3/5V490SDS | SDS | A-1 | 1 1/16 | 1 5/16 | 4.8 |
| 5.20 | 5.10 | 2/5V520SDS | SDS | A-1 | 11/16 | 1 5/16 | 4.6 | 3/5V520SDS | SDS | A-1 | 1 1/16 | 1 5/16 | 5.9 |
| 5.50 | 5.40 | 2/5V550SDS | SDS | A-1 | 11/16 | 1 5/16 | 5.1 | 3/5V550SDS | SDS | A-1 | 1 1/16 | 1 5/16 | 6.6 |
| 5.90 | 5.80 | 2/5V590SDS | SDS | A-1 | 11/16 | 1 5/16 | 5.6 | 3/5V590SDS | SDS | A-1 | 1 1/16 | 1 5/16 | 7.5 |
| 6.30 | 6.20 | 2/5V630SK | SK | C-1 | 7/16 | 1 15/16 | 7.4 | 3/5V630SK | SK | A-1 | 1 1/16 | 1 15/16 | 9.3 |
| 6.70 | 6.60 | 2/5V670SK | SK | C-1 | 7/16 | 1 15/16 | 7.5 | 3/5V670SK | SK | A-1 | 1 1/8 | 1 15/16 | 10.8 |
| 7.10 | 7.00 | 2/5V710SK | SK | C-1 | 7/16 | 1 15/16 | 7.9 | 3/5V710SF | SF | A-1 | 1 1/8 | 2 1/16 | 11.4 |
| 7.50 | 7.40 | 2/5V750SK | SK | C-1 | 7/16 | 1 15/16 | 8.7 | 3/5V750SF | SF | A-1 | 1 1/8 | 2 1/16 | 12.5 |
| 8.00 | 7.90 | 2/5V800SK | SK | C-2 | 7/16 | 1 15/16 | 10.0 | 3/5V800SF | SF | A-1 | 1 1/8 | 2 1/16 | 12.7 |
| 8.50 | 8.40 | 2/5V850SK | SK | C-2 | 7/16 | 1 15/16 | 10.8 | 3/5V850SF | SF | A-2 | 1 1/8 | 2 1/16 | 14.5 |
| 9.00 | 8.90 | 2/5V900SK | SK | C-2 | 7/16 | 1 15/16 | 11.4 | 3/5V900SF | SF | A-2 | 1 1/8 | 2 1/16 | 15.6 |
| 9.25 | 9.15 | 2/5V925SK | SK | C-2 | 7/16 | 1 15/16 | 12.0 | 3/5V925SF | SF | A-2 | 1 1/8 | 2 1/16 | 21.7 |
| 9.75 | 9.65 | 2/5V975SK | SK | C-2 | 7/16 | 1 15/16 | 12.6 | 3/5V975SF | SF | A-2 | 1 1/8 | 2 1/16 | 17.0 |
| 10.30 | 10.20 | 2/5V1030SK | SK | C-2 | 7/16 | 1 15/16 | 14.5 | 3/5V1030SF | SF | A-2 | 1 1/8 | 2 1/16 | 18.2 |
| 10.90 | 10.80 | 2/5V1090SK | SK | C-2 | 7/16 | 1 15/16 | 15.5 | 3/5V1090SF | SF | A-2 | 1 1/8 | 2 1/16 | 19.4 |
| 11.30 | 11.20 | 2/5V1130SK | SK | C-3 | 7/16 | 1 15/16 | 14.3 | 3/5V1130SF | SF | A-2 | 1 1/8 | 2 1/16 | 20.0 |
| 11.80 | 11.70 | 2/5V1180SK | SK | C-3 | 7/16 | 1 15/16 | 17.1 | 3/5V1180SF | SF | A-2 | 1 1/8 | 2 1/16 | 21.2 |
| 12.50 | 12.40 | 2/5V1250SF | SF | C-3 | 7/16 | 2 1/16 | 18.8 | 3/5V1250E | E | C-2 | 3/4 | 2 3/4 | 28.3 |
| 13.20 | 13.10 | 2/5V1320SF | SF | C-3 | 7/16 | 2 1/16 | 19.8 | 3/5V1320E | E | C-3 | 3/4 | 2 3/4 | 30.0 |
| 14.00 | 13.90 | 2/5V1400SF | SF | C-3 | 7/16 | 2 1/16 | 22.3 | 3/5V1400E | E | C-3 | 3/4 | 2 3/4 | 31.1 |
| 15.00 | 14.90 | 2/5V1500SF | SF | C-3 | 7/16 | 2 1/16 | 23.9 | 3/5V1500E | E | C-3 | 3/4 | 2 3/4 | 32.5 |
| 16.00 | 15.90 | 2/5V1600SF | SF | C-3 | 7/16 | 2 1/16 | 26.0 | 3/5V1600E | E | C-3 | 3/4 | 2 3/4 | 35.6 |
| 18.70 | 18.60 | 2/5V1870SF | SF | C-3 | 7/16 | 2 1/16 | 32.6 | 3/5V1870E | E | C-3 | 3/4 | 2 3/4 | 42.8 |
| 21.20 | 21.10 | 2/5V2120SF | SF | C-3 | 7/16 | 2 1/16 | 38.0 | 3/5V2120E | E | C-3 | 3/4 | 2 3/4 | 49.4 |
| 23.60 | 23.50 | 2/5V2360E | E | C-3 | 1/16 | 2 3/4 | 46.0 | 3/5V2360E | E | C-3 | 3/4 | 2 3/4 | 56.4 |
| 28.00 | 27.90 | 2/5V2800E | E | C-3 | 1/16 | 2 3/4 | 71.0 | 3/5V2800E | E | C-3 | 3/4 | 2 3/4 | 70.0 |
| 31.50 | 31.40 | | | | | | | 3/5V3150F | F | F-3 | 1/8 | 3 3/4 | 95.0 |
| 37.50 | 37.40 | | | | | | | 3/5V3750F | F | F-3 | 1/8 | 3 3/4 | 151.5 |
| 50.00 | 49.90 | | | | | | | 3/5V5000F | F | F-3 | 1/8 | 3 3/4 | 185.0 |

* = Can only be mounted from one direction.

Note: Cast iron sheaves may not exceed 6500 FPM.
This speed **DOES NOT** specify if dynamic balancing
(2 plane) is required. Contact customer service to
verify whether dynamic balancing is required.

QD Bushing Sheaves

Cast Iron Sheaves - Heavy Duty
Bushed, Four and Five Groove
5V QD Sheaves

Order part number size
Example: 4/5V440SD



For 5V & 5VX Belts
See pages 113, 115 & 116.
Order QD bushings separately.
Stock Bushings Located on Pages 84-85.

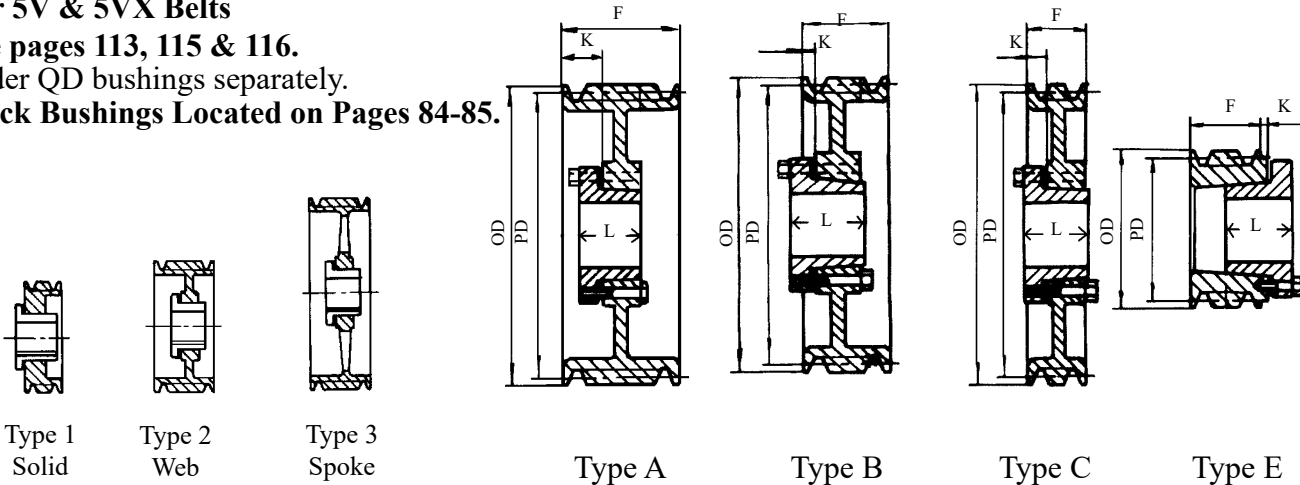

| Diameters | | 4 Groove F = 3 1/16 | | | | | | 5 Groove F = 3 3/4 | | | | | |
|-----------|-------|---------------------|------|------|--------|---------|-------|--------------------|------|------|--------|---------|-------|
| O.D. | P.D. | Part No. | Bush | Type | K | L | WT. | Part No. | Bush | Type | K | L | WT. |
| 4.40 | 4.30 | *4/5V440SD | SD | E-1 | 0 | 1 13/16 | 5.4 | *5/5V440SD | SD | E-1 | 0 | 1 13/16 | 6.4 |
| 4.65 | 4.55 | *4/5V465SD | SD | E-1 | 0 | 1 13/16 | 6.3 | *5/5V465SD | SD | E-1 | 0 | 1 13/16 | 7.2 |
| 4.90 | 4.80 | 4/5V490SD | SD | A-1 | 1 5/16 | 1 13/16 | 6.8 | 5/5V490SD | SD | A-1 | 1 5/16 | 1 13/16 | 7.8 |
| 5.20 | 5.10 | 4/5V520SD | SD | A-1 | 1 5/16 | 1 13/16 | 7.7 | 5/5V520SD | SD | A-1 | 1 5/16 | 1 13/16 | 9.0 |
| 5.50 | 5.40 | 4/5V550SD | SD | A-1 | 1 5/16 | 1 13/16 | 8.9 | 5/5V550SD | SD | A-1 | 1 5/16 | 1 13/16 | 10.2 |
| 5.90 | 5.80 | 4/5V590SD | SD | A-1 | 1 5/16 | 1 13/16 | 10.2 | 5/5V590SK | SK | A-1 | 1 5/16 | 1 15/16 | 10.8 |
| 6.30 | 6.20 | 4/5V630SK | SK | A-1 | 1 5/16 | 1 15/16 | 10.8 | 5/5V630SK | SK | A-1 | 1 5/16 | 1 15/16 | 12.3 |
| 6.70 | 6.60 | 4/5V670SK | SK | A-1 | 1 5/16 | 1 15/16 | 12.4 | 5/5V670SF | SF | A-1 | 1 3/8 | 2 1/16 | 13.4 |
| 7.10 | 7.00 | 4/5V710SF | SF | A-1 | 1 1/16 | 2 1/16 | 13.4 | 5/5V710SF | SF | A-1 | 1 3/8 | 2 1/16 | 15.2 |
| 7.50 | 7.40 | 4/5V750SF | SF | A-1 | 1 1/16 | 2 1/16 | 15.1 | 5/5V750SF | SF | A-1 | 1 3/8 | 2 1/16 | 16.9 |
| 8.00 | 7.90 | 4/5V800E | E | B-1 | 1 7/16 | 2 3/4 | 18.0 | 5/5V800E | E | A-1 | 1 3/4 | 2 3/4 | 19.7 |
| 8.50 | 8.40 | 4/5V850E | E | B-1 | 1 7/16 | 2 3/4 | 20.1 | 5/5V850E | E | A-1 | 1 3/4 | 2 3/4 | 23.1 |
| 9.00 | 8.90 | 4/5V900E | E | B-1 | 1 7/16 | 2 3/4 | 22.3 | 5/5V900E | E | A-1 | 1 3/4 | 2 3/4 | 26.4 |
| 9.25 | 9.15 | 4/5V925E | E | B-1 | 1 7/16 | 2 3/4 | 23.9 | 5/5V925E | E | A-1 | 1 3/4 | 2 3/4 | 28.3 |
| 9.75 | 9.65 | 4/5V975E | E | B-2 | 1 7/16 | 2 3/4 | 23.3 | 5/5V975E | E | A-2 | 1 3/4 | 2 3/4 | 26.2 |
| 10.30 | 10.20 | 4/5V1030E | E | B-2 | 1 7/16 | 2 3/4 | 25.5 | 5/5V1030E | E | A-2 | 1 3/4 | 2 3/4 | 28.5 |
| 10.90 | 10.80 | 4/5V1090E | E | B-2 | 1 7/16 | 2 3/4 | 28.0 | 5/5V1090E | E | A-2 | 1 3/4 | 2 3/4 | 30.7 |
| 11.30 | 11.20 | 4/5V1130E | E | B-2 | 1 7/16 | 2 3/4 | 28.5 | 5/5V1130E | E | A-2 | 1 3/4 | 2 3/4 | 32.3 |
| 11.80 | 11.70 | 4/5V1180E | E | B-2 | 1 7/16 | 2 3/4 | 29.9 | 5/5V1180E | E | A-2 | 1 3/4 | 2 3/4 | 33.5 |
| 12.50 | 12.40 | 4/5V1250E | E | B-2 | 1 7/16 | 2 3/4 | 31.2 | 5/5V1250E | E | A-2 | 1 3/4 | 2 3/4 | 36.3 |
| 13.20 | 13.10 | 4/5V1320E | E | B-2 | 1 7/16 | 2 3/4 | 33.7 | 5/5V1320E | E | A-2 | 1 3/4 | 2 3/4 | 38.4 |
| 14.00 | 13.90 | 4/5V1400E | E | B-3 | 1 7/16 | 2 3/4 | 34.4 | 5/5V1400E | E | A-3 | 1 3/4 | 2 3/4 | 40.0 |
| 15.00 | 14.90 | 4/5V1500E | E | B-3 | 1 7/16 | 2 3/4 | 37.0 | 5/5V1500E | E | A-3 | 1 3/4 | 2 3/4 | 42.7 |
| 16.00 | 15.90 | 4/5V1600E | E | B-3 | 1 7/16 | 2 3/4 | 39.6 | 5/5V1600E | E | A-3 | 1 3/4 | 2 3/4 | 58.0 |
| 18.70 | 18.60 | 4/5V1870E | E | A-3 | 1 1/4 | 2 3/4 | 51.8 | 5/5V1870F | F | B-3 | 1 1/4 | 3 3/4 | 67.0 |
| 21.20 | 21.10 | 4/5V2120E | E | A-3 | 1 1/4 | 2 3/4 | 58.3 | 5/5V2120F | F | B-3 | 1 1/4 | 3 3/4 | 88.0 |
| 23.60 | 23.50 | 4/5V2360F | F | C-3 | 7/8 | 3 3/4 | 70.0 | 5/5V2360F | F | B-3 | 1 1/4 | 3 3/4 | 114.9 |
| 28.00 | 27.90 | 4/5V2800F | F | C-3 | 7/8 | 3 3/4 | 92.0 | 5/5V2800F | F | B-3 | 1 1/4 | 3 3/4 | 126.0 |
| 31.50 | 31.40 | 4/5V3150F | F | C-3 | 7/8 | 3 3/4 | 108.0 | 5/5V3150J | J | C-3 | 9/16 | 4 5/8 | 132.0 |
| 37.50 | 37.40 | 4/5V3750F | F | C-3 | 7/8 | 3 3/4 | 138.0 | 5/5V3750J | J | C-3 | 9/16 | 4 5/8 | 174.0 |
| 50.00 | 49.90 | 4/5V5000J | J | B-3 | 1/8 | 4 5/8 | 227.0 | 5/5V5000J | J | C-3 | 9/16 | 4 5/8 | 247.0 |

* = Can only be mounted from one direction.
Note: Cast iron sheaves may not exceed 6500 FPM.
 This speed **DOES NOT** specify if dynamic balancing
 (2 plane) is required. Contact customer service to verify
 whether dynamic balancing is required.

Cast Iron Sheaves - Heavy Duty
Bushed, Six and Seven Groove
5V QD Sheaves
Order part number size
Example: 6/5V440SD



For 5V & 5VX Belts
See pages 113, 115 & 116.
Order QD bushings separately.
Stock Bushings Located on Pages 84-85.

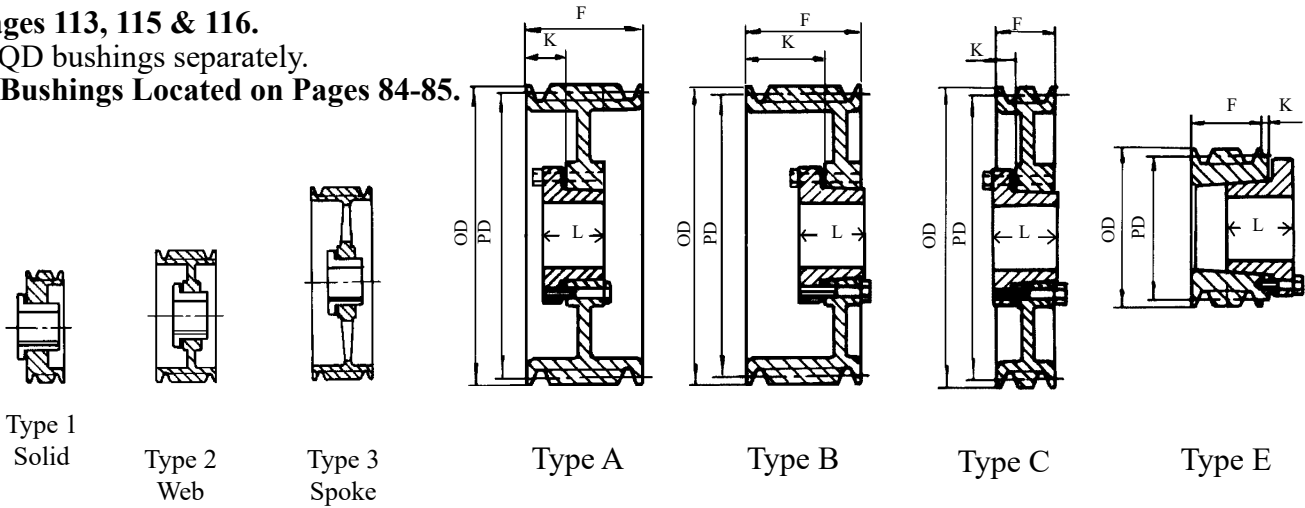

| Diameters | | 6 Groove F = 4 7/16 | | | | | | 7 Groove F = 5 1/8 | | | | | |
|-----------|-------|---------------------|------|------|---------|---------|-------|--------------------|------|------|--------|--------|------|
| O.D. | P.D. | Part No. | Bush | Type | K | L | WT. | Part No. | Bush | Type | K | L | WT. |
| 4.40 | 4.30 | *6/5V440SD | SD | E-1 | 0 | 1 13/16 | 7.7 | | | | | | |
| 4.65 | 4.55 | *6/5V465SD | SD | E-1 | 0 | 1 13/16 | 8.1 | | | | | | |
| 4.90 | 4.80 | 6/5V490SD | SD | A-1 | 1 5/16 | 1 13/16 | 8.1 | | | | | | |
| 5.20 | 5.10 | 6/5V520SD | SD | A-1 | 1 5/16 | 1 13/16 | 10.5 | | | | | | |
| 5.50 | 5.40 | 6/5V550SD | SD | A-1 | 1 5/16 | 1 13/16 | 12.0 | | | | | | |
| 5.90 | 5.80 | 6/5V590SK | SK | A-1 | 1 5/16 | 1 15/16 | 12.6 | | | | | | |
| 6.30 | 6.20 | 6/5V630SK | SK | A-1 | 1 5/16 | 1 15/16 | 14.5 | | | | | | |
| 6.70 | 6.60 | 6/5V670SF | SF | A-1 | 1 5/8 | 2 1/16 | 15.4 | | | | | | |
| 7.10 | 7.00 | 6/5V710SF | SF | A-1 | 1 5/8 | 2 1/16 | 17.4 | 7/5V710SF | SF | A-1 | 2 1/8 | 2 1/16 | 17.7 |
| 7.50 | 7.40 | 6/5V750SF | SF | A-1 | 1 5/8 | 2 1/16 | 19.4 | 7/5V750SF | SF | A-1 | 2 1/8 | 2 1/16 | 20.1 |
| 8.00 | 7.90 | 6/5V800E | E | A-1 | 2 | 2 3/4 | 22.7 | 7/5V800E | E | A-1 | 2 1/2 | 2 3/4 | 23.8 |
| 8.50 | 8.40 | 6/5V850E | E | A-1 | 2 | 2 3/4 | 26.0 | 7/5V850E | E | A-1 | 2 1/2 | 2 3/4 | 26.5 |
| 9.00 | 8.90 | 6/5V900E | E | A-1 | 2 | 2 3/4 | 29.4 | 7/5V900E | E | A-1 | 2 1/2 | 2 3/4 | 32.0 |
| 9.25 | 9.15 | 6/5V925E | E | A-1 | 2 | 2 3/4 | 30.8 | 7/5V925F | F | A-1 | 2 9/16 | 3 3/4 | 37.5 |
| 9.75 | 9.65 | 6/5V975E | E | A-2 | 2 | 2 3/4 | 35.0 | 7/5V975F | F | A-1 | 2 9/16 | 3 3/4 | 43.0 |
| 10.30 | 10.20 | 6/5V1030E | E | A-2 | 2 | 2 3/4 | 33.0 | 7/5V1030F | F | A-1 | 2 9/16 | 3 3/4 | 44.3 |
| 10.90 | 10.80 | 6/5V1090E | E | A-2 | 2 | 2 3/4 | 35.6 | 7/5V1090F | F | A-2 | 2 9/16 | 3 3/4 | 45.5 |
| 11.30 | 11.20 | 6/5V1130E | E | A-2 | 2 | 2 3/4 | 36.7 | 7/5V1130F | F | A-2 | 2 9/16 | 3 3/4 | 47.0 |
| 11.80 | 11.70 | 6/5V1180E | E | A-2 | 2 | 2 3/4 | 41.4 | 7/5V1180F | F | A-2 | 2 9/16 | 3 3/4 | 50.0 |
| 12.50 | 12.40 | 6/5V1250F | F | B-2 | 15/16 | 3 3/4 | 45.2 | 7/5V1250F | F | A-2 | 2 9/16 | 3 3/4 | 53.3 |
| 13.20 | 13.10 | 6/5V1320F | F | B-2 | 15/16 | 3 3/4 | 50.0 | 7/5V1320F | F | A-2 | 2 9/16 | 3 3/4 | 56.0 |
| 14.00 | 13.90 | 6/5V1400F | F | B-2 | 15/16 | 3 3/4 | 52.6 | 7/5V1400F | F | A-2 | 2 9/16 | 3 3/4 | 60.5 |
| 15.00 | 14.90 | 6/5V1500F | F | B-3 | 15/16 | 3 3/4 | 55.2 | 7/5V1500F | F | A-2 | 2 9/16 | 3 3/4 | 65.0 |
| 16.00 | 15.90 | 6/5V1600F | F | B-3 | 1 15/16 | 3 3/4 | 58.0 | 7/5V1600F | F | A-2 | 2 9/16 | 3 3/4 | 71.0 |
| 18.70 | 18.60 | 6/5V1870F | F | A-3 | 1 5/16 | 3 3/4 | 70.0 | 7/5V1870J | J | A-3 | 1 9/16 | 4 5/8 | 91.0 |
| 21.20 | 21.10 | 6/5V2120F | F | A-3 | 1 5/16 | 3 3/4 | 81.0 | | | | | | |
| 23.60 | 23.50 | 6/5V2360J | J | B-3 | 1 1/4 | 4 5/8 | 117.5 | | | | | | |
| 28.00 | 27.90 | 6/5V2800J | J | B-3 | 1 1/4 | 4 5/8 | 125.0 | | | | | | |
| 31.50 | 31.40 | 6/5V3150J | J | B-3 | 1 1/4 | 4 5/8 | 200.0 | | | | | | |
| 37.50 | 37.40 | 6/5V3750J | J | B-3 | 1 1/4 | 4 5/8 | 235.0 | | | | | | |
| 50.00 | 49.90 | 6/5V5000M | M | C-3 | 3/4 | 6 3/4 | 330.0 | | | | | | |

* = Can only be mounted from one direction.
Note: Cast iron sheaves may not exceed 6500 FPM.
 This speed **DOES NOT** specify if dynamic balancing (2 plane) is required. Contact customer service to verify whether dynamic balancing is required.

QD Bushing Sheaves

Cast Iron Sheaves - **Heavy Duty**
Bushed, **Eight and Ten Groove**
Order part number size
Example: 8/5V710SF



For 5V & 5VX Belts

See pages 113, 115 & 116.

Order QD bushings separately.

Stock Bushings Located on Pages 84-85.

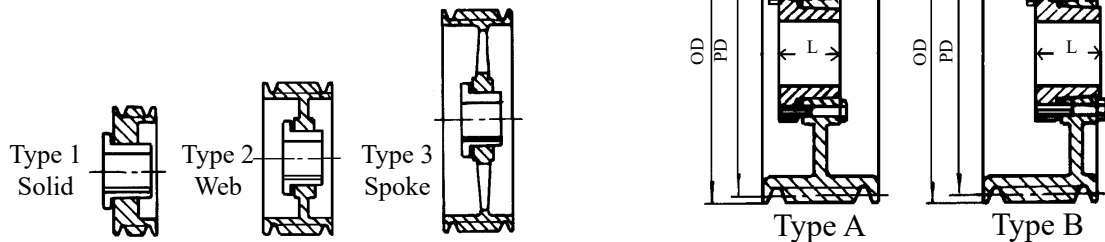

| Diameters | | 8 Groove F = 5 13/16 | | | | | | 10 Groove F = 7 3/16 | | | | | |
|-----------|-------|----------------------|------|------|--------|--------|-------|----------------------|------|------|---------|-------|-------|
| O.D. | P.D. | Part No. | Bush | Type | K | L | WT. | Part No. | Bush | Type | K | L | WT. |
| 7.10 | 7.00 | 8/5V710SF | SF | A-1 | 2 1/8 | 2 1/16 | 20.7 | | | | | | |
| 7.50 | 7.40 | 8/5V750SF | SF | A-1 | 2 1/8 | 2 1/16 | 23.1 | | | | | | |
| 8.00 | 7.90 | 8/5V800E | E | A-1 | 2 1/2 | 2 3/4 | 26.8 | 10/5V800E | E | A-1 | 3 1/4 | 2 3/4 | 30.9 |
| 8.50 | 8.40 | 8/5V850E | E | A-1 | 2 1/2 | 2 3/4 | 29.5 | 10/5V850E | E | A-1 | 3 1/4 | 2 3/4 | 34.9 |
| 9.00 | 8.90 | 8/5V900E | E | A-1 | 2 1/2 | 2 3/4 | 35.0 | 10/5V900F | F | A-1 | 3 5/16 | 3 3/4 | 43.7 |
| 9.25 | 9.15 | 8/5V925F | F | A-1 | 2 9/16 | 3 3/4 | 40.5 | 10/5V925F | F | A-1 | 3 5/16 | 3 3/4 | 45.6 |
| 9.75 | 9.65 | 8/5V975F | F | A-1 | 2 9/16 | 3 3/4 | 46.0 | 10/5V975F | F | A-1 | 3 5/16 | 3 3/4 | 51.0 |
| 10.30 | 10.20 | 8/5V1030F | F | A-1 | 2 9/16 | 3 3/4 | 47.3 | 10/5V1030F | F | A-1 | 3 5/16 | 3 3/4 | 59.0 |
| 10.90 | 10.80 | 8/5V1090F | F | A-2 | 2 9/16 | 3 3/4 | 48.5 | 10/5V1090F | F | A-2 | 3 5/16 | 3 3/4 | 65.5 |
| 11.30 | 11.20 | 8/5V1130F | F | A-2 | 2 9/16 | 3 3/4 | 50.0 | 10/5V1130F | F | A-2 | 3 5/16 | 3 3/4 | 60.8 |
| 11.80 | 11.70 | 8/5V1180F | F | A-2 | 2 9/16 | 3 3/4 | 53.0 | 10/5V1180F | F | A-2 | 3 5/16 | 3 3/4 | 63.0 |
| 12.50 | 12.40 | 8/5V1250F | F | A-2 | 2 9/16 | 3 3/4 | 56.3 | 10/5V1250J | J | A-2 | 3 9/16 | 4 5/8 | 71.3 |
| 13.20 | 13.10 | 8/5V1320F | F | A-2 | 2 9/16 | 3 3/4 | 59.0 | 10/5V1320J | J | A-2 | 3 9/16 | 4 5/8 | 79.5 |
| 14.00 | 13.90 | 8/5V1400F | F | A-2 | 2 9/16 | 3 3/4 | 63.5 | 10/5V1400J | J | A-2 | 3 9/16 | 4 5/8 | 88.0 |
| 15.00 | 14.90 | 8/5V1500F | F | A-2 | 2 9/16 | 3 3/4 | 68.0 | 10/5V1500J | J | A-2 | 3 9/16 | 4 5/8 | 94.5 |
| 16.00 | 15.90 | 8/5V1600F | F | A-2 | 2 9/16 | 3 3/4 | 74.0 | 10/5V1600J | J | A-2 | 3 9/16 | 4 5/8 | 101.2 |
| 18.70 | 18.60 | 8/5V1870J | J | A-3 | 1 9/16 | 4 5/8 | 94.0 | 10/5V1870J | J | A-3 | 1 9/16 | 4 5/8 | 109.6 |
| 21.20 | 21.10 | 8/5V2120J | J | A-3 | 1 9/16 | 4 5/8 | 106.0 | 10/5V2120J | J | A-3 | 1 9/16 | 4 5/8 | 122.0 |
| 23.60 | 23.50 | 8/5V2360J | J | A-3 | 1 9/16 | 4 5/8 | 120.0 | 10/5V2360M | M | B-3 | 1 15/16 | 6 3/4 | 174.0 |
| 28.00 | 27.90 | 8/5V2800J | J | A-3 | 1 9/16 | 4 5/8 | 145.0 | 10/5V2800M | M | B-3 | 1 15/16 | 6 3/4 | 214.0 |
| 31.50 | 31.40 | 8/5V3150M | M | B-3 | 5/8 | 6 3/4 | 196.2 | 10/5V3150M | M | B-3 | 1 15/16 | 6 3/4 | 238.0 |
| 37.50 | 37.40 | 8/5V3750M | M | B-3 | 5/8 | 6 3/4 | 248.0 | 10/5V3750M | M | B-3 | 1 15/16 | 6 3/4 | 283.0 |
| 50.00 | 49.90 | 8/5V5000M | M | B-3 | 5/8 | 6 3/4 | 367.0 | 10/5V5000M | M | B-3 | 1 15/16 | 6 3/4 | 427.0 |

Note: Cast iron sheaves may not exceed 6500 FPM.
This speed **DOES NOT** specify if dynamic balancing
(2 plane) is required. Contact customer service to verify
whether dynamic balancing is required.

Cast Iron Sheaves - Heavy Duty
Bushed, **Four, Five, Six and Seven Groove**
8V QD Sheaves
Order part number size
Example: 4/8V1250F

For 8V Belts. See pages 113, 117 & 118.
Order QD bushings separately.
Stock Bushings Located on Pages 84-85.

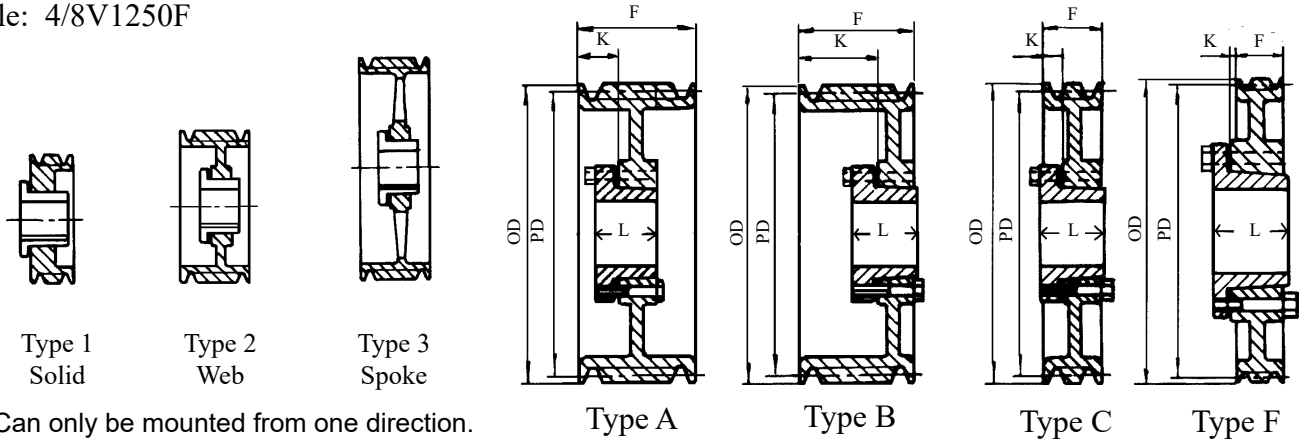

| Diameters | | 4 Groove F = 4 7/8 | | | | | | 5 Groove F = 6 | | | | | |
|-----------|-------|--------------------|------|------|---------|-------|--------|--------------------|------|------|---------|-------|-------|
| O.D. | P.D. | Part No. | Bush | Type | K | L | WT. | Part No. | Bush | Type | K | L | WT. |
| 12.50 | 12.30 | 4/8V1250F | F | A-2 | 1 3/16 | 3 3/4 | 60.0 | 5/8V1250F | F | A-2 | 2 5/16 | 3 3/4 | 82.8 |
| 13.20 | 13.00 | 4/8V1320F | F | A-2 | 1 3/16 | 3 3/4 | 64.0 | 5/8V1320F | F | A-2 | 2 5/16 | 3 3/4 | 96.0 |
| 14.00 | 13.80 | 4/8V1400F | F | A-2 | 1 3/16 | 3 3/4 | 68.3 | 5/8V1400F | F | A-2 | 2 5/16 | 3 3/4 | 81.0 |
| 15.00 | 14.80 | 4/8V1500F | F | A-2 | 1 3/16 | 3 3/4 | 72.6 | 5/8V1500F | F | A-2 | 2 5/16 | 3 3/4 | 84.5 |
| 16.00 | 15.80 | 4/8V1600F | F | A-2 | 1 3/16 | 3 3/4 | 77.0 | 5/8V1600F | F | A-2 | 2 5/16 | 3 3/4 | 95.5 |
| 17.00 | 16.80 | 4/8V1700F | F | A-3 | 1 3/16 | 3 3/4 | 83.5 | 5/8V1700J | J | A-2 | 2 | 4 5/8 | 104.5 |
| 18.00 | 17.80 | 4/8V1800F | F | A-3 | 1 3/16 | 3 3/4 | 90.0 | 5/8V1800J | J | A-2 | 2 | 4 5/8 | 115.2 |
| 19.00 | 18.80 | 4/8V1900F | F | A-3 | 1 3/16 | 3 3/4 | 112.0 | 5/8V1900J | J | A-3 | 2 | 4 5/8 | 122.0 |
| 20.00 | 19.80 | 4/8V2000J | J | A-3 | 1 7/16 | 4 5/8 | 114.0 | 5/8V2000J | J | A-3 | 2 | 4 5/8 | 133.0 |
| 21.20 | 21.00 | 4/8V2120J | J | A-3 | 1 7/16 | 4 5/8 | 140.0 | 5/8V2120J | J | A-3 | 2 | 4 5/8 | 140.0 |
| 22.40 | 22.20 | 4/8V2240J | J | A-3 | 1 7/16 | 4 5/8 | 150.0 | 5/8V2240M | M | B-3 | 13/16 | 6 3/4 | 182.0 |
| 24.80 | 24.60 | 4/8V2480M | M | F-3 | 5/16 | 6 3/4 | 211.0 | 5/8V2480M | M | B-3 | 13/16 | 6 3/4 | 201.0 |
| 30.00 | 29.80 | 4/8V3000M | M | F-3 | 5/16 | 6 3/4 | 264.0 | 5/8V3000M | M | B-3 | 13/16 | 6 3/4 | 254.0 |
| 35.50 | 35.30 | 4/8V3550M | M | F-3 | 5/16 | 6 3/4 | 367.0 | 5/8V3550M | M | B-3 | 13/16 | 6 3/4 | 298.0 |
| 40.00 | 39.80 | 4/8V4000M | M | F-3 | 5/16 | 6 3/4 | 300.0 | 5/8V4000M | M | B-3 | 13/16 | 6 3/4 | 337.0 |
| 44.50 | 44.30 | 4/8V4450M | M | C-3 | 13/16 | 6 3/4 | 350.0 | 5/8V4450N | N | C-3 | 15/16 | 8 1/8 | 375.0 |
| 53.00 | 52.80 | 4/8V5300M | M | C-3 | 13/16 | 6 3/4 | 400.0 | 5/8V5300N | N | F-3 | 1/4 | 8 1/8 | 625.0 |
| Diameters | | 6 Groove F = 7 1/8 | | | | | | 7 Groove F = 8 1/4 | | | | | |
| O.D. | P.D. | Part No. | Bush | Type | K | L | WT. | Part No. | Bush | Type | K | L | WT. |
| 12.50 | 12.30 | 6/8V1250F | F | A-2 | 2 5/16 | 3 3/4 | 81.0 | 7/8V1250J | J | A-1 | 3 9/16 | 4 5/8 | 113.0 |
| 13.20 | 13.00 | 6/8V1320F | F | A-2 | 2 5/16 | 3 3/4 | 85.4 | 7/8V1320J | J | A-1 | 3 9/16 | 4 5/8 | 127.0 |
| 14.00 | 13.80 | 6/8V1400F | F | A-2 | 2 5/16 | 3 3/4 | 96.0 | 7/8V1400J | J | A-2 | 3 9/16 | 4 5/8 | 123.0 |
| 15.00 | 14.80 | 6/8V1500J | J | A-2 | 2 9/16 | 4 5/8 | 110.0 | 7/8V1500J | J | A-2 | 3 15/16 | 4 5/8 | 142.0 |
| 16.00 | 15.80 | 6/8V1600J | J | A-2 | 2 9/16 | 4 5/8 | 118.0 | 7/8V1600J | J | A-2 | 3 15/16 | 4 5/8 | 160.0 |
| 17.00 | 16.80 | 6/8V1700J | J | A-2 | 2 9/16 | 4 5/8 | 126.0 | 7/8V1700M | M | A-2 | 3 15/16 | 6 3/4 | 226.0 |
| 18.00 | 17.80 | 6/8V1800J | J | A-2 | 2 9/16 | 4 5/8 | 133.0 | 7/8V1800M | M | A-2 | 3 15/16 | 6 3/4 | 228.0 |
| 19.00 | 18.80 | 6/8V1900J | J | A-3 | 2 9/16 | 4 5/8 | 157.0 | 7/8V1900M | M | A-2 | 3 15/16 | 6 3/4 | 220.0 |
| 20.00 | 19.80 | 6/8V2000M | M | B-3 | 15/16 | 6 3/4 | 185.0 | 7/8V2000M | M | A-3 | 3 15/16 | 6 3/4 | 210.0 |
| 21.20 | 21.00 | 6/8V2120M | M | B-3 | 1 15/16 | 6 3/4 | 194.0 | | | | | | |
| 22.40 | 22.20 | 6/8V2240M | M | B-3 | 1 15/16 | 6 3/4 | 221.0 | | | | | | |
| 24.80 | 24.60 | 6/8V2480M | M | B-3 | 1 15/16 | 6 3/4 | 248.0 | | | | | | |
| 30.00 | 29.80 | 6/8V3000M | M | B-3 | 1 15/16 | 6 3/4 | 276.0 | | | | | | |
| 35.50 | 35.30 | 6/8V3550N | N | C-3 | 1 1/8 | 8 1/8 | 444.0 | | | | | | |
| 40.00 | 39.80 | 6/8V4000N | N | C-3 | 1 1/8 | 8 1/8 | 519.0 | | | | | | |
| 44.50 | 44.30 | 6/8V4450N | N | C-3 | 7/8 | 8 1/8 | 600.0 | | | | | | |
| 53.00 | 52.80 | 6/8V5300N | N | C-3 | 7/8 | 8 1/8 | 768.0 | | | | | | |
| 63.00 | 62.80 | *6/8V6300P | P | C-3 | 2 | 9 3/8 | 890.0 | | | | | | |
| 71.00 | 70.80 | *6/8V7100P | P | C-3 | 2 | 9 3/8 | 1000.0 | | | | | | |

Note: Cast iron sheaves may not exceed 6500 FPM. This speed **DOES NOT** specify if dynamic balancing (2 plane) is required. Contact customer service to verify whether dynamic balancing is required.

QD Bushing Sheaves

Cast Iron Sheaves - **Heavy Duty**
Bushed, **Eight and Ten Groove**

Order part number size

Example: 8/8V1250J

For 8V Belts.

See pages 113, 117 & 118.

Order QD bushings separately.

Stock Bushings Located on Pages 84-85.

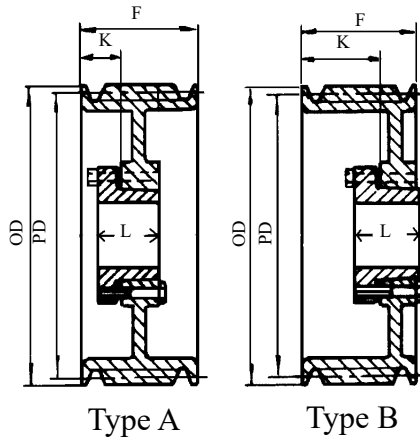
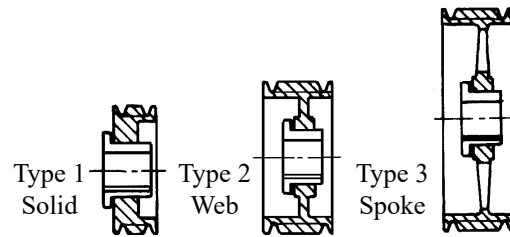

| Diameters | | 8 Groove F = 9 3/8 | | | | | | 10 Groove F = 11 5/8 | | | | | |
|-----------|-------|--------------------|------|------|---------|--------|--------|----------------------|------|------|---------|--------|--------|
| O.D. | P.D. | Part No. | Bush | Type | K | L | WT. | Part No. | Bush | Type | K | L | WT. |
| 12.50 | 12.30 | 8/8V1250J | J | A-1 | 3 9/16 | 4 5/8 | 117.0 | 10/8V1250J | J | A-1 | 3 9/16 | 4 5/8 | 134.0 |
| 13.20 | 13.00 | 8/8V1320J | J | A-2 | 3 9/16 | 4 5/8 | 131.0 | 10/8V1320J | J | A-1 | 3 9/16 | 4 5/8 | 150.5 |
| 14.00 | 13.80 | 8/8V1400J | J | A-2 | 3 9/16 | 4 5/8 | 127.0 | 10/8V1400J | J | A-1 | 3 9/16 | 4 5/8 | 167.0 |
| 15.00 | 14.80 | 8/8V1500J | J | A-2 | 3 15/16 | 4 5/8 | 146.0 | 10/8V1500M | M | A-1 | 3 15/16 | 6 3/4 | 225.0 |
| 16.00 | 15.80 | 8/8V1600J | J | A-2 | 3 15/16 | 4 5/8 | 162.0 | 10/8V1600M | M | A-1 | 3 15/16 | 6 3/4 | 263.0 |
| 17.00 | 16.80 | 8/8V1700M | M | A-2 | 3 15/16 | 6 3/4 | 228.0 | 10/8V1700M | M | A-2 | 3 15/16 | 6 3/4 | 267.5 |
| 18.00 | 17.80 | 8/8V1800M | M | A-2 | 3 15/16 | 6 3/4 | 230.0 | 10/8V1800M | M | A-2 | 3 15/16 | 6 3/4 | 272.0 |
| 19.00 | 18.80 | 8/8V1900M | M | A-2 | 3 15/16 | 6 3/4 | 222.0 | 10/8V1900M | M | A-2 | 3 15/16 | 6 3/4 | 269.0 |
| 20.00 | 19.80 | 8/8V2000M | M | A-2 | 3 15/16 | 6 3/4 | 213.0 | 10/8V2000M | M | A-3 | 3 15/16 | 6 3/4 | 253.0 |
| 21.20 | 21.00 | 8/8V2120M | M | A-3 | 3 15/16 | 6 3/4 | 230.0 | 10/8V2120M | M | A-3 | 3 15/16 | 6 3/4 | 267.0 |
| 22.40 | 22.20 | 8/8V2240M | M | A-3 | 3 15/16 | 6 3/4 | 244.0 | 10/8V2240N | N | A-2 | 2 1/4 | 8 1/8 | 332.0 |
| 24.80 | 24.60 | 8/8V2480N | N | A-3 | 2 1/4 | 8 1/8 | 365.7 | 10/8V2480N | N | A-3 | 2 1/4 | 8 1/8 | 356.0 |
| 30.00 | 29.80 | 8/8V3000N | N | A-3 | 2 1/4 | 8 1/8 | 410.0 | 10/8V3000N | N | A-3 | 2 1/4 | 8 1/8 | 425.0 |
| 35.50 | 35.30 | 8/8V3550N | N | A-3 | 2 1/4 | 8 1/8 | 508.0 | *10/8V3550P | P | A-3 | 2 5/8 | 9 3/8 | 635.0 |
| 40.00 | 39.80 | 8/8V4000N | N | A-3 | 2 1/4 | 8 1/8 | 592.0 | *10/8V4000P | P | A-3 | 2 5/8 | 9 3/8 | 754.0 |
| 44.50 | 44.30 | *8/8V4450P | P | B-3 | 2 5/8 | 9 3/8 | 860.0 | *10/8V4450P | P | A-3 | 2 5/8 | 9 3/8 | 813.5 |
| 53.00 | 52.80 | *8/8V5300P | P | B-3 | 2 5/8 | 9 3/8 | 992.0 | *10/8V5300P | P | A-3 | 1 3/4 | 9 3/8 | 1137.0 |
| 63.00 | 62.80 | *8/8V6300P | P | B-3 | 2 5/8 | 9 3/8 | 1050.0 | *10/8V6300W | W | A-3 | 2 5/8 | 11 3/8 | 1500.0 |
| 71.00 | 70.80 | *8/8V7100W | W | B-3 | 2 1/4 | 11 3/8 | 1808.0 | *10/8V7100W | W | A-3 | 2 5/8 | 11 3/8 | 1916.0 |

* = Can only be mounted from one direction.

Note: Cast iron sheaves may not exceed 6500 FPM.

This speed **DOES NOT** specify if dynamic balancing (2 plane) is required. Contact customer service to verify whether dynamic balancing is required.

9 Groove & Severe Duty Ductile Iron Sheaves (Max Rim Speed = 8,000FPM) are available upon request.

Cast Iron Sheaves - **Heavy Duty**
Bushed, **Twelve Groove**
Order part number size
Example: 12/8V1250M
For 8V Belts.
See pages 113, 117 & 118.
Order QD bushings separately.
Stock Bushings Located on Pages 84-85.

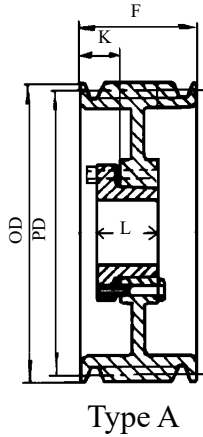
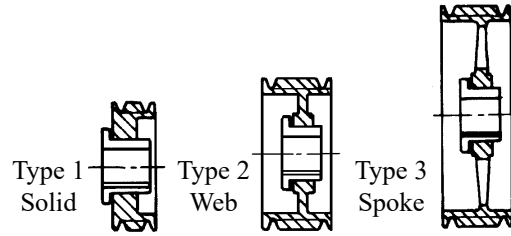

| Diameters | | 12 Groove F = 13 7/8 | | | | | |
|-----------|-------|----------------------|------|------|---------|--------|--------|
| O.D. | P.D. | Part No. | Bush | Type | K | L | WT. |
| 12.50 | 12.30 | 12/8V1250M | M | A-1 | 3 15/16 | 6 3/4 | 198.4 |
| 13.20 | 13.00 | 12/8V1320M | M | A-1 | 3 15/16 | 6 3/4 | 220.5 |
| 14.00 | 13.80 | 12/8V1400M | M | A-1 | 3 15/16 | 6 3/4 | 242.5 |
| 15.00 | 14.80 | 12/8V1500M | M | A-1 | 3 15/16 | 6 3/4 | 275.6 |
| 16.00 | 15.80 | 12/8V1600M | M | A-1 | 3 15/16 | 6 3/4 | 313.1 |
| 17.00 | 16.80 | 12/8V1700M | M | A-1 | 3 15/16 | 6 3/4 | 348.3 |
| 18.00 | 17.80 | 12/8V1800M | M | A-2 | 3 15/16 | 6 3/4 | 352.7 |
| 19.00 | 18.80 | 12/8V1900N | N | A-2 | 2 1/16 | 8 1/8 | 396.8 |
| 20.00 | 19.80 | 12/8V2000N | N | A-2 | 2 1/16 | 8 1/8 | 421.1 |
| 21.20 | 21.00 | 12/8V2120N | N | A-2 | 2 1/16 | 8 1/8 | 452.0 |
| 22.40 | 22.20 | 12/8V2240N | N | A-2 | 2 1/16 | 8 1/8 | 485.0 |
| 24.80 | 24.60 | 12/8V2480N | N | A-2 | 2 1/16 | 8 1/8 | 515.9 |
| 30.00 | 29.80 | *12/8V3000P | P | A-3 | 2 3/8 | 9 3/8 | 646.0 |
| 35.50 | 35.30 | *12/8V3550P | P | A-3 | 2 3/8 | 9 3/8 | 754.0 |
| 35.50 | 35.30 | *12/8V3550W | W | A-3 | 2 3/8 | 11 3/8 | 869.1 |
| 40.00 | 39.80 | *12/8V4000P | P | A-3 | 2 3/8 | 9 3/8 | 870.9 |
| 44.50 | 44.30 | *12/8V4450P | P | A-3 | 2 3/8 | 9 3/8 | 992.1 |
| 53.00 | 52.80 | *12/8V5300W | W | A-3 | 2 5/8 | 11 3/8 | 1410.0 |
| 63.00 | 62.80 | *12/8V6300W | W | A-3 | 2 7/8 | 11 3/8 | 1700.0 |
| 71.00 | 70.80 | *12/8V7100W | W | A-3 | 2 7/8 | 11 3/8 | 2000.0 |

* = Can only be mounted from one direction.
Note: Cast iron sheaves may not exceed 6500 FPM.
This speed **DOES NOT** specify if dynamic balancing (2 plane) is required. Contact customer service to verify whether dynamic balancing is required.

Severe Duty Ductile Iron Sheaves
(Max Rim Speed = 8,000FPM) are available upon request.