

Cast Iron Sheaves - Light Duty  
Bored-to Size- One Groove  
AK17 to AK184

for 3L, 4L or A Belts. See pages 100-103.  
Ordering part number size + bore  
Example: AK20-1/2  
AK39-1-1/8

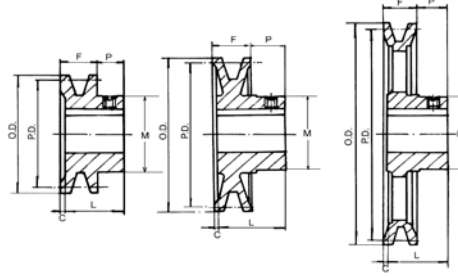

Type 1      Type 2      Type 3  
s = solid, ● lh = lighting hole, ⊕ sp = spoked ⊗

**AK**

Part No.	Diameters			Type	Dimensions				Stock Bores Inch	Hub Dia M	Av. Wgt.
	O.D.	3L	4L or A		F	L	P	C			
AK17	1.75	1.16	1.50	1 s	21/32	15/16	7/16	5/32	1/2, 5/8	1.6	.40
AK20	2.00	1.46	1.80	1 s	21/32	15/16	7/16	5/32	1/2, 5/8, 3/4	1.6	.53
AK21	2.10	1.56	1.90	1 s	21/32	15/16	7/16	5/32	1/2, 5/8, 3/4	1.6	.57
AK22	2.20	1.66	2.00	1 s	21/32	15/16	7/16	5/32	1/2, 5/8, 3/4	1.6	.60
AK23	2.30	1.76	2.10	1 s	21/32	15/16	7/16	5/32	1/2, 5/8, 3/4, 7/8	1.6	.63
AK25	2.50	1.96	2.30	2 s	21/32	15/16	7/16	5/32	1/2, 5/8, 3/4, 7/8	1.6	.73
AK26	2.60	2.06	2.40	2 s	21/32	15/16	7/16	5/32	1/2, 5/8, 3/4, 7/8	1.6	.75
AK27	2.70	2.16	2.50	2 s	21/32	15/16	7/16	5/32	1/2, 5/8, 3/4, 7/8	1.6	.83
AK28	2.80	2.26	2.60	2 s	21/32	15/16	7/16	5/32	1/2, 5/8, 3/4, 7/8, 1	1.6	.84
AK30	3.05	2.46	2.80	2 s	21/32	15/16	7/16	5/32	1/2, 5/8, 3/4, 7/8, 1	1.6	.98
AK32	3.25	2.66	3.00	2 s	21/32	15/16	7/16	5/32	1/2, 5/8, 3/4, 7/8, 1	1.6	1.1
AK34	3.45	2.86	3.20	2 s	21/32	15/16	7/16	5/32	1/2, 5/8, 3/4, 7/8, 1	1.6	1.2
AK39	3.75	3.16	3.50	2 s	3/4	1 5/32	15/32	1/16	5/8, 3/4, 7/8, 15/16, 1, 1/2, 1 1/8	1.6	1.5
AK41	3.95	3.36	3.70	2 s	3/4	1 5/32	15/32	1/16	5/8, 3/4, 7/8, 15/16, 1, 1/2, 1 1/8	1.6	1.8
AK44	4.25	3.66	4.00	3 s	3/4	1 5/32	15/32	1/16	5/8, 3/4, 7/8, 15/16, 1, 1/2, 1 1/8	1.6	1.9
AK46	4.45	3.86	4.20	3 s	3/4	1 5/32	15/32	1/16	5/8, 3/4, 7/8, 15/16, 1, 1/2, 1 1/8	1.6	2.0
AK49	4.75	4.16	4.50	3 s	3/4	1 5/32	15/32	1/16	5/8, 3/4, 7/8, 15/16, 1, 1/2, 1 1/8	1.6	2.2
AK51	4.95	4.36	4.70	3 s	3/4	1 5/32	15/32	1/16	5/8, 3/4, 7/8, 1, 1/2, 1 1/8	1.6	2.4
AK54	5.25	4.66	5.00	3 s	3/4	1 5/32	15/32	1/16	5/8, 3/4, 7/8, 15/16, 1, 1/2, 1 1/8, 1 3/16	1.6	2.6
AK56	5.45	4.86	5.20	3 s	3/4	1 5/32	15/32	1/16	5/8, 3/4, 7/8, 15/16, 1, 1/2, 1 1/8, 1 3/16	1.6	2.7
AK59	5.75	5.16	5.50	3 s	3/4	1 5/32	15/32	1/16	5/8, 3/4, 7/8, 15/16, 1, 1/2, 1 1/8, 1 3/16	1.6	2.9
AK61	5.95	5.36	5.70	3 s	3/4	1 5/32	15/32	1/16	5/8, 3/4, 7/8, 15/16, 1, 1/2, 1 1/8, 1 3/16	1.6	3.2
AK64	6.25	5.66	6.00	3 lh	3/4	1 5/32	15/32	1/16	5/8, 3/4, 7/8, 15/16, 1, 1/2, 1 1/8, 1 3/16	1.6	3.0

Part No.	Diameters			Type	Dimensions				Stock Bores Inch	Hub Dia M	Av. Wgt.
	O.D.	3L	4L or A		F	L	P	C			
AK66	6.45	5.86	6.20	3 lh	3/4	1 5/32	15/32	1/16	5/8, 3/4, 1, 1 1/8	1.6	3.1
AK69	6.75	6.16	6.50	3 lh	3/4	1 15/32	23/32	0	3/4, 7/8, 1, 1 1/8	1.6	3.5
AK71	6.95	6.36	6.70	3 lh	3/4	1 15/32	23/32	0	5/8, 3/4, 7/8, 1, 1 1/8, 1 7/16	1.6	3.8
AK74	7.25	6.66	7.00	3 lh	3/4	1 15/32	23/32	0	5/8, 3/4, 15/16, 1, 1 1/8, 1 3/16, 1 1/4, 1/2, 1 7/16	1.6	4.2
AK79	7.75	7.16	7.50	3 lh	3/4	1 15/32	23/32	0	3/4, 1, 1 1/8, 1 7/16	1.6	4.5
AK84	8.25	7.66	8.00	3 lh	3/4	1 15/32	23/32	0	5/8, 3/4, 15/16, 1, 1 3/16, 1/2, 1 7/16	1.6	5.0
AK89	8.75	8.16	8.50	3 lh	3/4	1 15/32	23/32	0	3/4, 1, 1 1/8, 1 7/16	1.6	5.4
AK94	9.25	8.66	9.00	3 lh	3/4	1 15/32	23/32	0	5/8, 3/4, 15/16, 1, 1 3/16, 1 1/4, 1/2, 1 7/16	1.6	5.9
AK99	9.75	9.16	9.50	3 sp	3/4	1 15/32	23/32	0	3/4, 1, 1 7/16	1.7	6.1
AK104	10.25	9.66	10.00	3 sp	3/4	1 15/32	23/32	0	5/8, 3/4, 1, 1 3/16, 1 1/4, 1 3/8, 1 7/16	1.7	6.9
AK109	10.75	10.16	10.50	3 sp	3/4	1 15/32	23/32	0	3/4, 1, 1 3/8, 1 7/16	1.7	7.3
AK114	11.25	10.66	11.00	3 sp	3/4	1 15/32	23/32	0	3/4, 1, 1 3/16, 1 7/16	1.7	7.4
AK124	12.25	11.66	12.00	3 sp	3/4	1 15/32	23/32	0	5/8, 3/4, 7/8, 1, 1 3/16, 1 1/4, 1 7/16	1.7	8.3
AK134	13.25	12.66	13.00	3 sp	3/4	1 15/32	23/32	0	3/4, 1, 1 3/16, 1 3/8, 1 7/16	1.7	9.3
AK144	14.25	13.66	14.00	3 sp	3/4	1 15/32	23/32	0	3/4, 1, 1 3/16, 1 7/16	1.7	10.8
AK154	15.25	14.66	15.00	3 sp	3/4	1 15/32	23/32	0	3/4, 1, 1 3/16, 1 3/8, 1 7/16	1.7	12.6
AK184	18.25	17.66	18.00	3 sp	3/4	1 15/32	23/32	0	3/4, 1, 1 3/16, 1 7/16	1.7	17.1

Standard Key Dimensions	
Shaft Dia.	Keyseat W x D
1/2	None
5/8 - 7/8	3/16 x 3/32
15/16 - 1 1/4	1/4 x 1/8
1 5/16 - 1 3/8	5/16 x 5/32
1 7/16 - 1 3/4	3/8 x 3/16

AK Sheaves are accurately machined from gray cast iron, statically balanced, painted and individually packaged. They are furnished with standard keyway & 2 set screws. All set screws are 5/16-18 knurled. Recommended tightening torque is 110-130 inch-lbs.

# Bored-To-Size Sheaves

Cast Iron Sheaves - **Light Duty**  
 Bored-to Size, **Two Groove**  
 2AK20 to 2AK184

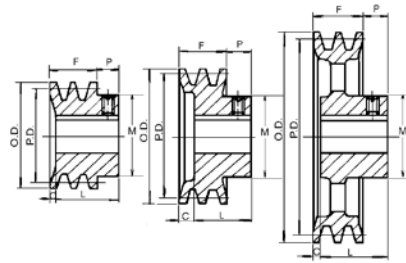

Type 1                      Type 2                      Type 3

s = solid, ● lh = lighting hole, ⊗ sp = spoked ⊗



**2AK**

Part No.	Diameters			Type	Dimensions				Stock Bores in Inches	Hub Dia M	Series Average Weight
	O.D.	"3L" Pitch	"4L or A" Pitch		F	L	P	C			
2AK20	2.00	1.46	1.80	1 s	1 3/8	1 21/32	15/32	3/16	1/2, 5/8, 3/4, 7/8	1.6	.83
2AK21	2.15	1.56	1.90	1 s	1 3/8	1 21/32	15/32	3/16	1/2, 5/8, 3/4	1.6	.97
2AK22	2.25	1.66	2.00	1 s	1 3/8	1 21/32	15/32	3/16	1/2, 5/8, 3/4, 7/8	1.6	1.0
2AK23	2.35	1.76	2.10	1 s	1 3/8	1 21/32	15/32	3/16	5/8, 3/4, 7/8, 1	1.7	1.1
2AK25	2.55	1.96	2.30	1 s	1 3/8	1 21/32	15/32	3/16	5/8, 3/4, 7/8, 1	1.7	1.3
2AK26	2.65	2.06	2.40	1 s	1 3/8	1 21/32	15/32	3/16	5/8, 3/4, 7/8, 1	1.7	1.4
2AK27	2.75	2.16	2.50	1 s	1 3/8	1 21/32	15/32	3/16	5/8, 3/4, 7/8, 1	1.9	1.6
2AK28	2.85	2.26	2.60	1 s	1 3/8	1 21/32	15/32	3/16	5/8, 3/4, 7/8, 1	1.9	1.7
2AK30	3.05	2.46	2.80	1 s	1 3/8	1 21/32	15/32	3/16	1/2, 5/8, 3/4, 7/8, 1, 1 1/8	1.9	2.0
2AK32	3.25	2.66	3.00	1 s	1 3/8	1 21/32	15/32	3/16	1/2, 5/8, 3/4, 7/8, 1, 1 1/8	1.9	2.3
2AK34	3.45	2.86	3.20	1 s	1 3/8	1 21/32	15/32	3/16	1/2, 5/8, 3/4, 7/8, 1, 1 1/8	1.9	2.5
2AK39	3.75	3.16	3.50	2 s	1 3/8	1 11/32	15/32	1/2	1/2, 5/8, 3/4, 7/8, 1, 1 1/8	1.9	2.6
2AK41	3.95	3.36	3.70	2 s	1 3/8	1 11/32	15/32	1/2	5/8, 3/4, 7/8, 1, 1 1/8	1.9	2.8
2AK44	4.25	3.66	4.00	2 s	1 3/8	1 11/32	15/32	1/2	5/8, 3/4, 7/8, 1, 1 1/8	1.9	3.2
2AK46	4.45	3.86	4.20	2 s	1 3/8	1 11/32	15/32	1/2	7/8, 1, 1 1/8	1.6	2.9
2AK49	4.75	4.16	4.50	2 s	1 3/8	1 11/32	15/32	1/2	3/4, 7/8, 1, 1 1/8, 1 3/8	1.9	3.2
2AK51	4.95	4.36	4.70	2 s	1 3/8	1 11/32	15/32	1/2	3/4, 7/8, 1, 1 1/8, 1 3/8	1.6	3.4
2AK54	5.25	4.66	5.00	3 s	1 3/8	1 11/32	15/32	1/2	5/8, 3/4, 7/8, 1, 1 1/8, 1 3/8	1.9	3.7
2AK56	5.45	4.86	5.20	3 s	1 3/8	1 11/32	15/32	1/2	5/8, 3/4, 1, 1 1/8, 1 3/8	1.6	3.9
2AK59	5.75	5.16	5.50	3 s	1 3/8	1 11/32	15/32	1/2	1, 1 1/8, 1 3/8	1.9	4.4
2AK61	5.95	5.36	5.70	3 s	1 3/8	1 11/32	15/32	1/2	3/4, 7/8, 1, 1 1/8, 1 3/8	1.6	4.5
2AK64	6.25	5.66	6.00	3 s	1 3/8	1 19/32	11/32	1/8	3/4, 1, 1 1/8, 1 3/16, 1 3/8, 1 7/16	1.7	5.2
2AK74	7.25	6.66	7.00	3 lh	1 3/8	1 19/32	11/32	1/8	3/4, 1, 1 1/8, 1 3/16, 1 3/8, 1 7/16	1.7	6.0
2AK84	8.25	7.66	8.00	3 lh	1 3/8	1 19/32	11/32	1/8	3/4, 15/16, 1, 1 1/8, 1 3/16, 1 1/4, 1 3/8, 1 7/16	1.7	7.0
2AK94	9.25	8.66	9.00	3 lh	1 3/8	1 19/32	11/32	1/8	3/4, 1, 1 1/8, 1 3/16, 1 3/8, 1 7/16	1.7	8.2
2AK104	10.25	9.66	10.00	3 sp	1 3/8	1 19/32	11/32	1/8	3/4, 15/16, 1, 1 7/16	1.7	9.6
2AK114	11.25	10.66	11.00	3 sp	1 3/8	1 19/32	11/32	1/8	3/4, 1, 1 3/16, 1 3/8, 1 7/16	1.7	11.2
2AK124	12.25	11.66	12.00	3 sp	1 3/8	1 19/32	11/32	1/8	3/4, 1, 1 3/16, 1 7/16	1.7	12.1
2AK134	13.25	12.66	13.00	3 sp	1 3/8	1 19/32	11/32	1/8	1 3/16, 1 7/16	2.2	13.6
2AK144	14.25	13.66	14.00	3 sp	1 3/8	1 19/32	11/32	1/8	1, 1 7/16	1.7	14.6
2AK154	15.25	14.66	15.00	3 sp	1 3/8	1 19/32	11/32	1/8	1 3/16, 1 7/16	2.2	16.5
2AK184	18.25	17.66	18.00	3 sp	1 3/8	1 19/32	11/32	1/8	1 3/16, 1 7/16	2.2	22.7

Standard Key Dimensions	
Shaft Dia.	Keyseat W x D
1/2	None
5/8 - 7/8	3/16 x 3/32
15/16 - 1 1/4	1/4 x 1/8
1 5/16 - 1 3/8	5/16 x 5/32
1 7/16 - 1 3/4	3/8 x 3/16

2AK Sheaves are accurately machined from gray cast iron, statically balanced, painted and individually packaged. They are furnished with standard keyway & 2 set screws. All set screws are 5/16-18 knurled. Recommended tightening torque is 110-130 inch-lbs.

Cast Iron Sheaves - Light Duty  
Bored-to Size, One Groove  
BK24 to BK190  
for 4L or A, 5L or B Belts. See pages  
100-108

Order part number size + bore  
Example: BK24-1/2

BK45-1-1/8

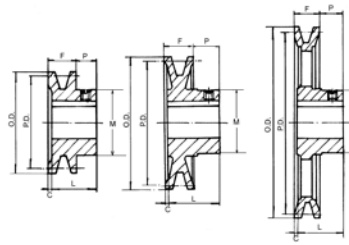

Type 1    Type 2    Type 3

s = solid, ● lh = lighting hole, ⊕ sp = spoked ⊗

**Bored-To-Size Sheaves**



**BK**

Part No.	Diameters			Type	Dimensions				Stock Bores in.	Hub Dia M	Series Av. Wgt.
	O.D.	4L or A	5L or B		F	L	P	C			
BK24	2.40	1.80	2.20	1 s	13/16	1 1/16	13/32	5/32	1/2, 5/8, 3/4, 7/8	1.6	.73
BK25	2.50	1.90	2.30	1 s	13/16	1 1/16	13/32	5/32	1/2, 5/8, 3/4, 7/8, 1	1.6	.74
BK26	2.60	2.00	2.40	1 s	13/16	1 1/16	13/32	5/32	1/2, 5/8, 3/4, 7/8	1.6	.80
BK27	2.70	2.10	2.50	2 s	13/16	1 1/16	13/32	5/32	1/2, 5/8, 3/4, 7/8, 1	1.6	.84
BK28	2.95	2.20	2.60	2 s	13/16	1 1/16	13/32	5/32	1/2, 5/8, 3/4, 7/8, 1, 1 1/8	1.6	1.0
BK30	3.15	2.40	2.80	2 s	13/16	1 1/16	13/32	5/32	1/2, 5/8, 3/4, 7/8, 1, 1 1/8	1.6	1.2
BK32	3.35	2.60	3.00	2 s	13/16	1 1/16	13/32	5/32	1/2, 5/8, 3/4, 7/8, 1, 1 1/8	1.6	1.2
BK34	3.55	2.80	3.20	2 s	7/8	1 5/32	13/32	1/8	1/2, 5/8, 3/4, 7/8, 1, 1 1/8	1.9	1.7
BK36	3.75	3.00	3.40	2 s	7/8	1 5/32	13/32	1/8	1/2, 5/8, 3/4, 7/8, 1, 1 1/8	1.9	1.9
BK40	3.95	3.20	3.60	2 s	7/8	1 5/32	13/32	1/8	1/2, 5/8, 3/4, 7/8, 1, 1 1/8	1.9	2.1
BK45	4.25	3.50	3.90	2 s	7/8	1 5/32	13/32	1/8	5/8, 3/4, 7/8, 1, 1 1/8	1.7	2.1
BK47	4.45	3.70	4.10	2 s	7/8	1 5/32	13/32	1/8	5/8, 3/4, 7/8, 1, 1 1/8	1.6	2.2
BK50	4.75	4.00	4.40	3 s	7/8	1 5/32	13/32	1/8	5/8, 3/4, 7/8, 1, 1 1/8	1.6	2.5
BK52	4.95	4.20	4.60	3 s	7/8	1 5/32	13/32	1/8	5/8, 3/4, 7/8, 1, 1 1/8	1.6	2.6
BK55	5.25	4.50	4.90	3 s	7/8	1 5/32	13/32	1/8	5/8, 3/4, 7/8, 1, 1 1/8	1.6	3.0
BK57	5.45	4.70	5.10	3 s	7/8	1 5/32	13/32	1/8	5/8, 3/4, 7/8, 1, 1 1/8	1.6	3.1
BK60	5.75	5.00	5.40	3 s	7/8	1 5/32	13/32	1/8	5/8, 3/4, 7/8, 1, 1 1/8	1.6	3.4
BK62	5.95	5.20	5.60	3 s	7/8	1 5/32	13/32	1/8	5/8, 3/4, 7/8, 1, 1 1/8	1.6	3.6
BK65	6.25	5.50	5.90	3 s	7/8	1 5/32	13/32	1/8	5/8, 3/4, 7/8, 1, 1 1/8	1.6	3.9
BK67	6.45	5.70	6.10	3 lh	7/8	1 5/32	13/32	1/8	5/8, 3/4, 7/8, 1, 1 1/8	1.6	3.7
BK70	6.75	6.00	6.40	3 s	7/8	1 15/32	21/32	1/16	5/8, 3/4, 7/8, 1, 1 1/8	1.6	4.6
BK72	6.95	6.20	6.60	3 lh	7/8	1 15/32	21/32	1/16	5/8, 3/4, 7/8, 1, 1 1/8	1.6	4.4

Part No.	Diameters			Type	Dimensions				Dia Stock Bores in.	Hub M	Series Average Weight
	O.D.	4L or A	5L or B		F	L	P	C			
BK75	7.25	6.50	6.90	3 lh	7/8	1 15/32	21/32	1/16	3/4, 1, 1 1/8, 1 3/8	1.6	4.6
BK77	7.45	6.70	7.10	3 lh	7/8	1 15/32	21/32	1/16	3/4, 1, 1 1/8, 1 3/8	1.6	5.1
BK80	7.75	7.00	7.40	3 lh	7/8	1 15/32	21/32	1/16	5/8, 3/4, 7/8, 1, 1 1/8, 1 3/8, 1 7/16	1.6	5.4
BK85	8.25	7.50	7.90	3 lh	7/8	1 15/32	21/32	1/16	3/4, 1, 1 1/8, 1 3/8, 1 7/16	1.6	5.8
BK90	8.75	8.00	8.40	3 lh	7/8	1 15/32	21/32	1/16	3/4, 7/8, 1, 1 1/8, 1 3/16, 1 7/16	1.6	6.1
BK95	9.25	8.50	8.90	3 lh	7/8	1 15/32	21/32	1/16	3/4, 1, 1 1/8, 1 3/8	1.6	7.0
BK100	9.75	9.00	9.40	3 lh	7/8	1 15/32	21/32	1/16	3/4, 7/8, 1, 1 1/8, 1 3/16, 1 7/16	1.6	7.4
BK105	10.25	9.50	9.90	3 lh	7/8	1 15/32	21/32	1/16	1, 1 3/8, 1 7/16	1.7	8.0
BK110	10.75	10.00	10.40	3 sp	7/8	1 15/32	21/32	1/16	3/4, 1, 1 1/8, 1 3/16, 1 7/16	1.7	8.5
BK115	11.25	10.50	10.90	3 sp	7/8	1 15/32	21/32	1/16	1, 1 7/16	1.7	8.9
BK120	11.75	11.00	11.40	3 sp	7/8	1 15/32	21/32	1/16	3/4, 1, 1 3/16, 1 7/16	1.7	10.0
BK130	12.75	12.00	12.40	3 sp	7/8	1 15/32	21/32	1/16	3/4, 1, 1 1/8, 1 3/16, 1 1/4	1.7	10.8
BK140	13.75	13.00	13.40	3 sp	7/8	1 15/32	21/32	1/16	3/4, 1, 1 3/16, 1 7/16	1.7	12.1
BK160	15.75	15.00	15.40	3 sp	7/8	1 15/32	21/32	1/16	1, 1 1/8, 1 3/16, 1 1/4	1.7	14.4
BK190	18.75	18.00	18.40	3 sp	7/8	1 15/32	21/32	1/16	1, 1 3/16, 1 1/4, 1 7/16	1.7	21.3

**MasterDrive Bore/Keyway Specifications**

Bore Size Nominal	Bore Size Nominal	G8 Tolerance		Key Tolerances Key Width Range		
Dimension (mm)	Dimension (inches)	(mm)	(inches)	>	<	inches
6-10	.2362-.3937	High Low	+0.027 mm +0.005 mm	High Low	+0.0010" +0.0001"	* * 1/2" +.002"
10-18	.3937-.7087	High Low	+0.033 mm +0.006 mm	High Low	+0.0013" +0.0002"	* * 3/4" 1" +.003"
18-30	.7087-1.1811	High Low	+0.040mm +0.007mm	High Low	+0.0016" +0.0003"	* * 1" 1 1/2" +.004"
30-50	1.1811-1.9685	High Low	+0.048mm +0.009mm	High Low	+0.0019" +0.0003"	* * * * *
50-80	1.9685-3.1496	High Low	+0.056mm +0.010mm	High Low	+0.0022" +0.0003"	* * * * *
80-120	3.1496-4.7244	High Low	+0.066mm +0.012mm	High Low	+0.0026" +0.0004"	* * * * *
120-180	4.7244-7.0866	High Low	+0.077mm +0.014mm	High Low	+0.0030" +0.0005"	* * * * *
180-250	7.0866-9.8425	High Low	+0.087mm +0.015mm	High Low	+0.0034" +0.0005"	* * * * *

Standard Key Dimensions	
Shaft Dia.	Keyseat W x D
1/2	None
5/8 - 7/8	3/16 x 3/32
15/16 - 1 1/4	1/4 x 1/8
1 5/16 - 1 3/8	5/16 x 5/32
1 7/16 - 1 3/4	3/8 x 3/16

BK Sheaves are accurately machined from gray cast iron, statically balanced, painted and individually packaged. They are furnished with standard keyway & 2 set screws. All set screws are 5/16-18 knurled. Recommended tightening torque is 110-130 inch-lbs.

# Bored-To-Size Sheaves

Cast Iron Sheaves - Light Duty  
 Bored-to Size, Two Groove  
 2BK25 to 2BK190  
 for 4L or A, 5L or B Belts. See pages  
 100-108

Order part number size + bore

Example: 2BK25-1/2

2BK47-1-1/8

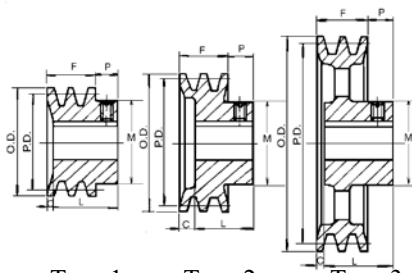

Type 1      Type 2      Type 3

s = solid, ● lh = lighting hole, ● sp = spoked ⊗

**MASTERDRIVE**  
 POWER TRANSMISSION PRODUCTS



**2BK**

Part No.	Diameters			Type	Dimensions				Stock Bores in Inches	Hub Dia M	Series Average Weight
	O.D.	Pitch "4L or A" "5L or B"			F	L	P	C			
2BK25	2.50	1.90	2.30	1 s	1 3/4	1 31/32	15/32	1/4	1/2, 5/8, 3/4, 7/8	1.6	1.5
2BK27	2.70	2.10	2.50	1 s	1 3/4	1 31/32	15/32	1/4	1/2, 5/8, 3/4, 7/8, 1, 1 1/8	1.7	1.7
2BK28	2.95	2.20	2.60	1 s	1 3/4	1 31/32	15/32	1/4	1/2, 5/8, 3/4, 7/8, 1, 1 1/8	1.9	2.1
2BK30	3.15	2.40	2.80	1 s	1 3/4	1 31/32	15/32	1/4	1/2, 5/8, 3/4, 7/8, 1, 1 1/8, 1 3/8	1.9	2.3
2BK32	3.35	2.60	3.00	1 s	1 3/4	1 31/32	15/32	1/4	5/8, 3/4, 7/8, 1, 1 1/8	1.6	2.7
2BK34	3.55	2.80	3.20	1 s	1 3/4	1 31/32	15/32	1/4	5/8, 3/4, 7/8, 1, 1 1/8	1.6	3.1
2BK36	3.75	3.00	3.40	1 s	1 3/4	1 31/32	15/32	1/4	5/8, 3/4, 7/8, 1, 1 1/8	1.6	3.4
2BK40	3.95	3.20	3.60	2 s	1 3/4	1 15/32	15/32	3/4	5/8, 3/4, 7/8, 1, 1 1/8	1.6	3.4
2BK45	4.25	3.50	3.90	2 s	1 3/4	1 15/32	15/32	3/4	1, 1 1/8, 1 3/8	1.9	4.0
2BK47	4.45	3.70	4.10	2 s	1 3/4	1 15/32	15/32	3/4	7/8, 1, 1 1/8, 1 3/8	1.6	4.2
2BK50	4.75	4.00	4.40	2 s	1 3/4	1 15/32	15/32	3/4	3/4, 1, 1 1/8, 1 3/8	1.6	4.8
2BK52	4.95	4.20	4.60	2 s	1 3/4	1 15/32	15/32	3/4	5/8, 7/8, 1, 1 1/8, 1 3/8	1.6	5.2
2BK55	5.25	4.50	4.90	2 s	1 3/4	1 15/32	15/32	3/4	1 1/8, 1 3/8	1.9	5.8
2BK57	5.45	4.70	5.10	2 s	1 3/4	1 15/32	15/32	3/4	1, 1 1/8, 1 3/8	1.9	5.4
2BK60	5.75	5.00	5.40	3 s	1 3/4	1 15/32	15/32	3/4	3/4, 7/8, 1, 1 1/8, 1 3/8	1.6	5.7
2BK62	5.95	5.20	5.60	3 s	1 3/4	1 15/32	15/32	3/4	1, 1 1/8, 1 3/8	1.9	6.0
2BK65	6.25	5.50	5.90	3 s	1 3/4	1 15/32	15/32	3/4	1, 1 1/8, 1 3/8	1.9	6.5
2BK67	6.45	5.70	6.10	3 s	1 3/4	1 15/32	15/32	3/4	1, 1 1/8, 1 3/8	1.9	6.8
2BK70	6.75	6.00	6.40	3 s	1 3/4	1 19/32	11/32	1/2	3/4, 1, 1 1/8, 1 3/16, 1 7/16	1.6	7.6
2BK80	7.75	7.00	7.40	3 lh	1 3/4	1 19/32	11/32	1/2	3/4, 1, 1 1/8, 1 3/16, 1 1/4, 1 3/8, 1 7/16	1.6	8.7
2BK90	8.75	8.00	8.40	3 lh	1 3/4	1 19/32	11/32	1/2	3/4, 1, 1 1/8, 1 3/16, 1 7/16	1.6	10.0
2BK100	9.75	9.00	9.40	3 lh	1 3/4	1 19/32	11/32	1/2	3/4, 1, 1 1/8, 1 3/16, 1 7/16	1.6	11.8
2BK110	10.75	10.00	10.40	3 sp	1 3/4	1 19/32	11/32	1/2	1, 1 3/16, 1 7/16	1.7	14.0
2BK120	11.75	11.00	11.40	3 sp	1 3/4	1 19/32	11/32	1/2	1, 1 3/16, 1 7/16	1.7	15.6
2BK130	12.75	12.00	12.40	3 sp	1 3/4	1 19/32	11/32	1/2	1, 1 3/16, 1 7/16	1.7	17.0
2BK140	13.75	13.00	13.40	3 sp	1 3/4	1 19/32	11/32	1/2	1, 1 3/16, 1 7/16	1.7	19.0
2BK160	15.75	15.00	15.40	3 sp	1 3/4	1 19/32	11/32	1/2	1, 1 3/16, 1 7/16	1.7	23.7
2BK190	18.75	18.00	18.40	3 sp	1 3/4	1 19/32	11/32	1/2	1 3/16, 1 1/4, 1 7/16	2.2	30.3

6 2BK Sheaves are accurately machined from gray cast iron, statically balanced, painted and individually packaged. They are furnished with standard keyway & 2 set screws. All set screws are 5/16-18 knurled. Recommended tightening torque is 110-130 inch-lbs.